

# AFTERMARKET COLLISION PARTS



## A BUMPERS

P/N HAO01002  
16" Chrome Bumper w/Tow Holes, Standard, Fits 167-1986 359 Conventional & 1967-1980 352 COE

P/N HAO01006  
18" Chrome Texas Square Rolled End Bumper w/Tow Holes, Fits 1967-1986 359 Conventional & 1967-1980 352 COE, Pictured Below



*More Bumpers Are Available - Please Call!*

## B HEADLIGHT & TURN SIGNALS

P/N 09-1606163 (Left)  
P/N 09-1606164 (Right)  
Polished Stainless Steel Dual Round Headlight Assembly w/Halogen Head Lamps, Pictured Below



P/N 29-1606149 (Left)  
P/N 29-1606150 (Right)  
Polished Stainless Steel Dual Round Headlight Assembly w/LED Head Lamps, Pictured Below



P/N 01-1606008  
Headlight Mounting Bracket

P/N 29-160699  
Dual Round Headlight Bucket Assembly  
*More Headlights & Bezels Are Available - Please Call!*

## C ENGINE COOLING PARTS FAN SHROUD

P/N 02-070605  
Fiberglass Fan Shroud, Needs Modification To Fit, Replaces OE K216-1982

## METAL RADIATORS

P/N 01-070218  
Copper Brass Radiator w/Frame, 4 Row, 37.5"H x 38.75"W, 2.375" Thickness, Flanged Inlet Upper Left & Right, Flanged Outlet Lower Right, Replaces OE 07-04449A011, 07-04449A022, Fits 1978-1987, Pictured Below



P/N 01-070264  
Copper Brass Radiator Core, 5 Row, 37.5"H x 38.75"W, 3" Thickness, Gaskets Sold Separately, Replaces OE 07-04449A011, 07-04449A022, Fits 1978-1987, Pictured Below



*More Replacement Radiators, Charge Air Cooler & AC Condensers Available - Please Call!*

## D HOODS & RELATED

P/N 01-12445 (Left)  
P/N 01-12446 (Right)  
Aftermarket Top Hood Panel, For Long Hood, Replaces OE 13-03467L, 13-03467R, Fits 1972-1986, Pictured Below



P/N 01-12447 (Left)  
P/N 01-12448 (Right)  
Aftermarket Side Hood Panel, For Long Hood, Replaces OE 13-03463, Fits 1972-1986, Pictured Below



P/N 01-12451  
Aftermarket Hood Cylinder w/Quick Release Shuttle Valve, Orifice Plug & .375 Ball Joint End, Corrosion Resistant Hard Coated Anodized Aluminum Tubes, Must Spray To Break Seals In Properly, Replace As A Pair, Replaces OE 349100, Pictured Below



P/N 01-12409  
Hood Hinge Repair Kit, 1 Kit Per Hinge, Replaces OE 13-03318, Fits 1972-1987

P/N 01-12400  
Hood Cone Support Kit, Includes Hood Rest, Mount Bushings Sleeve & Washer Nuts, Replaces OE 13-01840

P/N 01-12429  
Hood Cone Support, Red Poly, Replaces OE 13-04609

P/N 01-12401  
Upper Hood Rest, Black Poly Center, Replaces OE 13-030114

P/N 01-12404  
Small Hood Roller, 1.375" O.D., .375" I.D., 1.625" Length, Replaces OE 13-03440

P/N 01-12405  
Large Hood Roller, 2" O.D., .375" I.D., 1.5" Length, Replaces OE 13-03439

P/N 01-12430  
Hood Guide Grommet, Black Poly, Replaces OE 13-03170, 13-03425

P/N 01-12717 (Left)  
P/N 01-12718 (Right)  
Aftermarket Aluminum Front Fenders, Replaces OE 15-04540M000L, 15-04540M000R, OEM Part Not An Aftermarket Part, Pictured Below



P/N 01-12601  
Chrome Fender Step, Sold As A Pair, Pictured Below



## E CAB & RELATED AIR CLEANERS

P/N 09-090515001  
15" Air Cleaner, Vortex Style w/Stainless Steel Housing & Oblong Holes On Screen, Single Bolt, Filter Element Not Included, Pictured Below



P/N 01-090550  
Intake Elbow, 68 Degree, Connects 7" O.D. To 6" O.D.

## WINDSHIELD WIPERS

P/N 01-0911006  
Windshield Wiper Conversion Kit, Converts Air To Electric, For Peterbilt 359, Complete Kit w/Washer Reservoir

\*\*\* High Quality Aftermarket Replacement Part (Not OEM Parts).

All items represented are aftermarket replacement parts. If you require OEM parts, please contact your nearest authorized Peterbilt dealer. Four State Trucks is not affiliated with Paccar or Peterbilt.

# AFTERMARKET COLLISION PARTS



## E CAB & RELATED (cont.) CAB LIGHTS

P/N 09-1608077  
Chrome Bullet Cab Light

## AIR HORNS & RELATED

P/N 09-0513127  
30" Chrome Hadley Style Air Horn

## DOOR ACCESSORIES

P/N 01-0914078 (Left)  
P/N 01-0914079 (Right)  
Stainless Steel Exterior Door Handle,  
Replaces OE 20-08179L, 20-08179R,  
Fits 1973-2004

P/N 01-0914050 (Left)  
P/N 01-0914051 (Left)  
Stainless Steel Door Hinge, Does Not Have  
Notch At Top For Wire Boot

## SLEEPER ACCESSORIES

P/N 01-091601  
Custom 1 Piece Fiberglass Roof Cap For 48"  
Sleeper, Includes Aluminum Roof Support  
Bracing, Replaces 3 Piece Roof Cap

## F TOOL BOXES

P/N 01-05010231  
Complete Aluminum Battery Box, Old Style,  
Diamond Plate Top & Step, Smooth  
Aluminum Sides, Pictured Below



P/N 01-0507007OE  
24" x 18" Logo Mud Flap For Battery  
Box/Tool Box, Replaces OE 1160B,  
Fits 1967-1987, OEM Part Not An  
Aftermarket Part

P/N 01-0507008OE  
24" x 14" Logo Mud Flap For Battery  
Box/Tool Box, Replaces OE 1163B,  
MF0001, Fits 1967-1987, OEM Part Not  
An Aftermarket Part

\*\*\* High Quality Aftermarket Replacement Part (Not OEM Parts).

All items represented are aftermarket replacement parts. If you require  
OEM parts, please contact your nearest authorized Peterbilt dealer.  
Four State Trucks is not affiliated with Paccar or Peterbilt.

## G FUEL TANKS & RELATED FUEL TANK ACCESSORIES

P/N 29-0601008 (w/Outside Lip)  
P/N 29-0601009 (w/o Outside Lip)  
4" Fuel Tank Strap Rubber Liner, Fits  
1989-2009, Sold By The Foot, Pictured Below



P/N 29-060313  
Adjustable Fuel Sender Fits 6" to 27" DIA.  
Tanks, 240 to 33 OHM, Pictured Below



P/N 29-060314  
.375" x 24" Steel Pick Up Tube, Cut To  
Fit Tank Depth, .5" Male Pipe Into Fuel  
Tank, .375" Female Pipe Thread In Top

P/N 29-060317  
.5" x 28" Steel Pick Up Tube, Cut To  
Fit Tank Depth, .5" Male Pipe Into Fuel  
Tank, .5" Female Pipe Thread In Top

## FUEL TANK CAPS

P/N 01-060301 (Non-Locking)  
P/N 01-060312 (Locking)  
Non-Vented Fuel Tank Cap w/Pressure  
Relief, Fits 1985-1987, Pictured Below



## FUEL TANK STRAPS

P/N 01-0601010  
P/N 01-0601011 (Bracket Only)  
4" Aftermarket Aluminum Satin Finish  
Fuel Tank Strap For 26" Dia. Fuel Tanks,  
Fuel Tank Strap Liner Sold Separately,  
Replaces OE 11-03596, Fits 1972-1987,  
Pictured Below



## FUEL TANKS

P/N 01-06008001 (Left)  
P/N 01-06008002 (Right)  
80 Gallon Aluminum Rear Fill Fuel Tank,  
26" x 38", Fits 1972-1987, Verify Which  
Style Manifold Tank Has, Pictured Below



P/N 01-060010003 (Left)  
P/N 01-060010004 (Right)  
100 Gallon Aluminum Rear Fill Fuel Tank,  
26" x 48", Fits 2006 & Older, Verify Which  
Style Manifold Tank Has

P/N 01-060012501 (Left)  
P/N 01-060012502 (Right)  
125 Gallon Aluminum Rear Fill Fuel Tank,  
26" x 57", Fits 1972-1987, Verify Which Style  
Manifold Tank Has

P/N 01-060013501 (Left)  
P/N 01-060013502 (Right)  
135 Gallon Aluminum Rear Fill Fuel Tank,  
26" x 66", Fits 2006 & Older, Verify Which  
Style Manifold Tank Has

P/N 01-060015001 (Left)  
P/N 01-060015002 (Right)  
150 Gallon Aluminum Rear Fill Fuel Tank,  
26" x 72", Fits 2006 & Older, Verify Which  
Style Manifold Tank Has, Pictured Below



## H FENDERS & RELATED

P/N 09-11050602  
Black Poly Quarter Fenders, Sold As A Pair  
P/N 09-110306041  
24" Stainless Steel Quarter Fender w/Tube,  
Mounts To Standard Post, Post Not  
Included, Sold As A Pair

P/N 09-11030600  
Stainless Steel Quarter Fenders w/Full  
Braces, 22" Height x 25" Wide, 13.5" From  
Bottom To Center Of Mount, Sold As A Pair

## NS CAB ACCESSORIES



1 P/N 01-1503002  
Chrome Round Defroster Vent  
2 P/N 01-1510502  
Fiberglass Dashboard Housing, Replaces  
OE 20-10406

3 P/N 01-151708 (Carpet)  
P/N 01-151709 (Vinyl)  
Black Flooring Kit, Includes Backing  
P/N 01-1513007  
Black Rubber Shift Boot, Replaces OE  
20-02071

P/N 01-1513003  
Shift Boot Trim Ring, Replaces OE  
20-01998, Fits 1973-1987, OEM Part Not An  
Aftermarket Part

# AFTERMARKET COLLISION PARTS

## EXHAUST PARTS FOR PETERBILT 359

- 1** P/N 09-08506001  
5" O.D. x 60" Turnout Chrome Top Stack,  
*Other Sizes Available*
- 2** P/N 09-0800009  
5" Stainless Steel Flat Band Clamp  
P/N 09-0800010  
5" Stainless Steel Preformed Band Clamp
- N/A** STAINLESS EXHAUST SHIELD,  
Includes Mount Brackets
- 3** P/N 29-080200  
5" I.D. x 10" Dia. Muffler
- 4** P/N 01-08117264  
Chrome Exhaust Elbow,  
*Replaces OE 14-01726C*
- 5** P/N 09-0804524  
5" x 24" Stainless Steel Flex Pipe
- 6** P/N 01-0806003  
Exhaust Y-Pipe, *Replaces OE 14-04055*
- N/A** 5" STEEL EXHAUST PIPE,  
*Sold By The Foot*
- 7** P/N 01-08133940  
Down Pipe Elbow, *Replaces OE 14-13394*
- 8** P/N 01-08130020  
Turbo Pipe w/Pyro Hole, *Replaces OE 14-14-13002*
- 9** P/N 29-080001  
5" Turbo V-Band Clamp

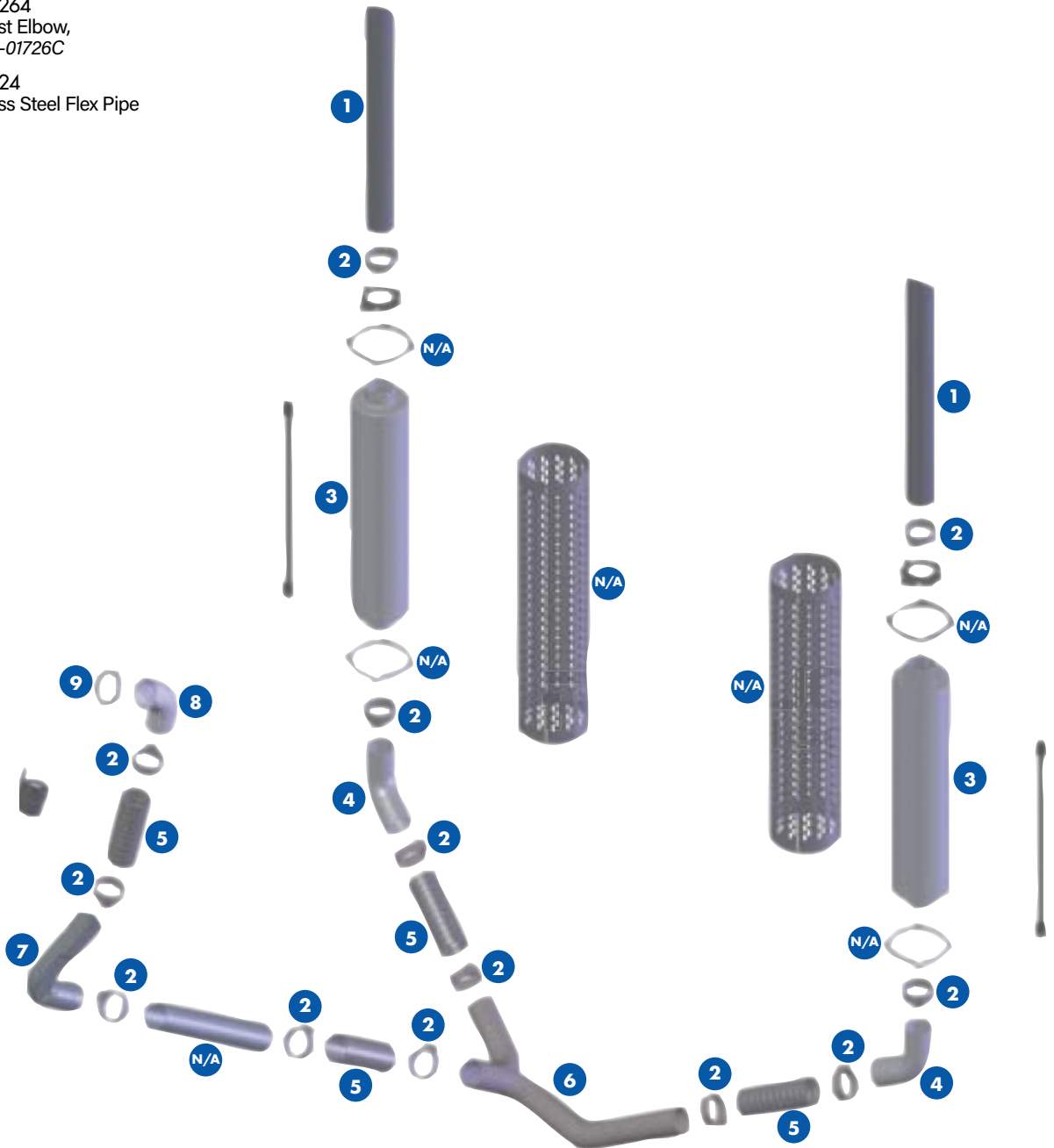

\*\*\* High Quality Aftermarket Replacement Part (Not OEM Parts).  
All items represented are aftermarket replacement parts. If you require OEM parts, please contact your nearest authorized Peterbilt dealer. Four State Trucks is not affiliated with Paccar or Peterbilt.