

# AFTERMARKET COLLISION PARTS



## A BUMPERS

P/N EM001024

10" Chrome Bumper OE Style w/Tow Holes, 2 Bolts Per Side To Mount, Fits 4700 Series 1990-2002, Fits 4900 Series 1989-2001

P/N EL001024

10" Chrome Bumper OE Style w/Tow Holes, 4 Bolts Per Side To Mount, Fits 4700 Series 1990-2002, Fits 4900 Series 1989-2001

P/N EM201024

10" Chrome Bumper OE Style w/Fog Light Cutouts & Tow Holes, 2 Bolts Per Side To Mount, Fits 4700 & 4900 Series 1990-2002, Pictured Below



## B HEADLIGHTS & TURN SIGNALS

P/N 07-1606008 (Left)

P/N 07-1606009 (Right)

Headlight Bezel, Replaces OE 1661763C1, 3000077C1, 1661764C1, 3000078C1, Fits 4700 & 4900 Series 1989-2001, Pictured Below



P/N 07-1607000 (Left)

P/N 07-1607001 (Right)

Amber Turn Signal Lens, Replaces OE 1661761C92, 1661761C93, 1661762C92, 1661762C93, Fits 4700 & 4900 Series 1989-2001, Pictured Below



P/N 07-1607002 (Left)

P/N 07-1607003 (Right)

Turn Signal Lamp w/ Clear Lens, Fits 4700 & 4900 Series 1989-2001

P/N 29-160674

Single Square Headlight Assembly, Left Or Right Side, Fits 4700 Series 1990-2002, Fits 4900 Series 1989-2001, Pictured Below



P/N 07-1606016

Headlight Adjuster Screw w/Plastic Base, Left Or Right Side, Replaces OE 505565C91, Fits 4700 Series 1990-2002, Fits 4700 & 4900 Series 1989-2001

## C ENGINE COOLING PARTS AC CONDENSERS

P/N 07-070007

AC Condenser, 26" x 26.625", .875" Thick, Replaces OE 1659054C91, 1659054C92, 1A16489G, 1A16490G, 1A17359G, 1A18582D, 1A19009D, 2000655C1, 2000655C2, 2004693C91, 2029208C91, 2037786C91, 2037786C92, 2037786C93, 3503905C91, 3507816C92, 3527216C91, 3527216C92, Fits 4700 & 4900 Series 1993-2002, Pictured Below



P/N 07-070003

AC Condenser, 25.5"H" x 27"W x .75" Core Thickness, Replaces OE 1667340C4, 1667340C5, 1667640C5, Fits 4700 Series 1989-1999, Fits 4900 Series 1990-2002, Pictured Below



## CHARGE AIR COOLERS

P/N 07-070103

Charge Air Cooler, 25.50"H x 27"W x .75" Core Thickness, Replaces OE 1030010V, 1030020, 1030232, 1030373, 1030413, 1030413A, 1646077C1, 1A17680, 1A17680G, 1A18785G, 1E0047610000, 1E3486, 1E3488, E3951G, 1E4761, 1E5070, 1S5070D, 2029812C1, 2229812C1, 2501403C1, 2507276C1, 3000154C1, 3515528C94, 3530996C1, Fits 4700 & 4900 Series 1995-2002, Pictured Below



P/N 07-070111

Charge Air Cooler, 23.375"H x 13"W x 3" Core Thickness, Replaces OE 1030035, 4854500002, 165054C91, 165055C91, 1659054C93, 1659055C93, 1696920C2, 1696955C1, 1696956C1, 1A16145G, 1A16489G, 1A17659G, 1A17360G, 1A18119D, 1A19009D, 1E0051040000, 1E3509G, 1E3835, 1E5104, 1E5104G, 2004693C91, 2004694C91, 3503905C92, 3503906C91, 3527216C92, Fits 4700 & 4900 Series 1990-2002, Pictured Below



P/N 29-070121

Charge Air Cooler, 23.5"H x 24"W x 1.687" Core Thickness, Replaces OE 1030039, 1659006C1, 3E7018, 818704, 91021, 1E0034900000, 507977, 99031501, 1030071, Fits 4700 Series 1995-2002, Pictured Below



## METAL RADIATORS



Call For More Info On Full & Split Style Radiators/Radiator Kits For Your Specific International 4700 & 4000 Series Model

\*\*\* High Quality Aftermarket Replacement Part (Not OEM Parts).

All items represented are aftermarket replacement parts. If you require OEM parts, please contact your nearest authorized International dealer. Four State Trucks is not affiliated with Navistar.

# AFTERMARKET COLLISION PARTS



## C ENGINE COOLING PARTS (cont.) COOLANT RESERVOIRS

P/N 07-070208

Coolant Reservoir, Replaces OE 2002105C1, 2002105C2, 2002105C3, 5C4Z-8A080-AA, Fits 4700 Series 1995-2002, Fits 4900 Series 1995-2001, Pictured Below



P/N 07-070212

Coolant Reservoir Cap, Replaces OE 2039390C3, Fits 4700 Series 1995-2002, Fits 4900 Series 1995-2001, Pictured Below



## AC DRIERS & RELATED

P/N 29-070041

3" x 10" AC Drier, Replaces OE 454613C1, 454614C1, 176570, 3918259, RDHRD549590P, 3949280, 8086753, 4379RD549590, Fits 4700 Series 1989-1997, Fits 4900 Series 1990-1997, Pictured Below



P/N 07-070024

3" x 10" AC Drier, Replaces OE 1693117C1, 2000821C1, 2000821C2, ABP N83 319925, YL194, 1676664C1, Fits 4700 Series 1989-1997, Fits 4900 Series 1990-1997

P/N 29-070033

AC Evaporator, 13" x 10" x 2.625", Replaces OE 1696844C1, 3949257, BOA80-377-00-089, BSM151311, Fits 4700 Series 1995-2000, Fits 4900 Series 1995-2002, Pictured Below



P/N 07-070027

AC Expansion Valve, Replaces OE 11691469C1, 3230218023, 176188, 3918219, 3949276, RDHRD558620P, Fits 4700 Series 1983-2000, Fits 4900 Series 1990-2000, Pictured Below

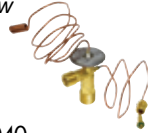

P/N 07-070040

AC Expansion Valve, Block Style, Replaces OE 1696846C1, 1696846C2, 1696876C3, 2503783C91, Fits 4700 Series 1995-2002, Fits 4900 Series 1995-2001, Pictured Below



## D HOODS & RELATED

P/N 07-12500

Aftermarket 1 Piece Fiberglass, Replacement Hood w/Grille, 76" Across Top Of Hood Where It Meets The Cab, 44.5" Front To Back On Top, 94" Across The Front Outside Fenders, Replaces OE 2023784C1, Fits 4700 Series 1990-2002, Fits 4900 Series 1989-2001, Pictured Below



P/N 07-12514

Aftermarket Low Profile Hood Shell, 76" Across Top Of Hood Where It Meets The Cab, 39.75" Front To Back On Top, 93" Across The Front Outside Fenders, Only Fits Lo Pro Tires 19.5, Replaces OE 1661723C1, 2030592C91, Fits 4700 Series 1990-2002, Fits 1989-2001, Pictured Below

P/N 07-124000

Hood Strap, Replaces OE 1699929C91, Fits 4700 Series 1990-2002, Fits 4900 Series 1989-2001, Pictured Below



P/N 07-124002

Hood Spring, Replaces OE 1675762C1, 1675762C2, 1675762C3, Fits 4700 Series 1990-2001, Fits 4900 Series 1989-2001

P/N 07-124010

Hood Stop Guide, Replaces OE 472698C1, Fits 4700 & 4900 Series 1989-2001, Pictured Below



P/N 07-124009

Hood Stop Guide Rubber, Replaces OE 472697C1, Fits 4700 Series 1990-2002, Fits 4900 Series 1989-2001, Pictured Below



## E FENDER EXTENSIONS

P/N 07-051201 (Left)

P/N 07-051211 (Right)

Fiberglass Fender Extensions, Replaces OE 1657748C1, 1657747C1, Fits 1989-2001, Pictured Below



## F WHEELS & ACCESSORIES

P/N 09-20132231 (22.5")

P/N 09-20132431 (24.5")

Accuride Aluminum Wheel, Steer/Drive, Pictured Below



P/N 09-2015221 (22.5")

P/N 09-2015241 (24.5")

White Steel Wheel, 10 Hole Hub, Steer/Drive, Pictured Below



\*\*\* High Quality Aftermarket Replacement Part (Not OEM Parts).

All items represented are aftermarket replacement parts. If you require OEM parts, please contact your nearest authorized International dealer. Four State Trucks is not affiliated with Navistar.

INTERNATIONAL 4700-4900

Fits

www.BestFitTruckParts.com  
855-220-8608

# AFTERMARKET COLLISION PARTS



## G CAB & RELATED MIRRORS & RELATED

P/N 09-0915011  
Stainless Steel Mirror Head, Fits 4700 & 4900 Series 1989-2001, Pictured Below



P/N 09-0915008  
Stainless Steel Heated/Lighted Mirror Head, Fits 4700 & 4900 Series 1989-2001

P/N 09-0915007  
Stainless Steel Heated Mirror Head, Fits 4700 & 4900 Series 1989-2001

P/N 09-0915006  
Stainless Steel Heated/Motorized Mirror Head, Fits 4700 & 4900 Series 1989-2001

P/N 07-0915010  
Aluminum Mirror Assembly w/Brackets, Fits 4700 & 4900 Series 1989-2001



P/N 09-0915003  
8.5" Stainless Steel Spot Mirror, Center Stud, Fits 4700 & 4900 Series 1989-2001

P/N 09-0915004  
8.5" Stainless Steel Spot Mirror, Offset Stud, Fits 4700 & 4900 Series 1989-2001

P/N 09-123003  
8" Fender Mount Convex Tripod Mirror, Fits 4700 & 4900 Series 1989-2001

P/N 09-123004  
8" Fender Mount Single Arm Mirror, Fits 4700 & 4900 Series 1989-2001, Pictured Below



P/N 09-0915005  
7.5" Stainless Steel Spot Mirror, Offset Stud, Fits 4700 & 4900 Series 1989-2001

P/N 29-091503  
8" x 17" Black Plastic Aero Mirror Head, Clamp On Mounting For .75"-1.25" Dia. Brackets, Fits 4700 & 4900 Series 1990-2002

P/N 29-091504  
8" x 17" Chrome Plastic Aero Mirror Head, Clamp On Mounting For .75"-1.25" Dia. Brackets, Fits 4700 & 4900 Series 1990-2002

P/N 29-091505  
8" x 8.5" Black Plastic Aero Convex Mirror Head, Clamp On Mounting For .75"-1.25" Dia. Brackets, Fits 4700 & 4900 Series 1990-2002, Pictured Below



P/N 29-091506  
8" x 8.5" Chrome Plastic Aero Convex Mirror Head, Clamp On Mounting For .75"-1.25" Dia. Brackets, Fits 4700 & 4900 Series 1990-2002

## DOOR ACCESSORIES

P/N 07-0914030  
Chrome Exterior Door Handles, Replaces OE 3550931C91, Fits 4700 Series 1990-2002, Fits 4900 Series 1989-2001, Pictured Below



P/N 07-1530006 (Left)  
P/N 07-1530007 (Right)  
Chrome Interior Door Handles, Replaces OE 1649758C1, 3518516C91, 1649759C1, 3518517C91, Fits 4700 Series 1990-2002, Fits 1989-2002, Pictured Below



P/N 07-1530004 (Left)  
P/N 07-1530005 (Right)  
Black Plastic Interior Door Handles, Replaces OE 1649758C1, 3518516C91, 1649759C1, 3518517C91, Fits 4700 & 4900 Series 1989-2001

## H FUEL TANKS & ACCESSORIES

P/N 07-060302  
Fuel Sender, 15" Tube Style w/OE Style Plug, Replaces OE 2585993C91, 3591593C1, 3864392C91, 3864392C92, Fits 4700 & 4900 Series 1989-2001, Pictured Below



P/N 09-060302  
Safety Vent 1/2" Thread, Fits 4700 & 4900 Series 1989-2001

P/N 09-060303  
Safety Vent 1/4" Thread, Replaces OE 10626GTD, Fits 4700 & 4900 Series 1989-2001, Pictured Below



## FUEL TANK CAPS

P/N 29-060312  
Non-Vented Aluminum Fuel Tank Cap, Replaces OE 3548221C2, Fits 4700 Series 1990-2002, Fits 4900 Series 1989-2001, Pictured Below



P/N 29-060320  
Non-Vented Aluminum Fuel Tank Cap, Replaces OE 3548221C2, 576745C91, Fits 4700 & 4900 Series 1979-1989

## FUEL TANKS STRAPS

P/N 09-060101  
2" Fuel Tank Strap Rubber w/Outside Lip, Fits 4700 & 4900 Series 1989-2001, Pictured Below



P/N 29-0601003  
1.875" Stainless Steel Fuel Tank Strap w/Upper Step Bracket, For 63 Gallon D Tanks, Fits 4700 & 4900 Series 1990-2002, Pictured Below



\*\*\* High Quality Aftermarket Replacement Part (Not OEM Parts).

All items represented are aftermarket replacement parts. If you require OEM parts, please contact your nearest authorized International dealer. Four State Trucks is not affiliated with Navistar.



# AFTERMARKET COLLISION PARTS

**INTERNATIONAL 4700-4900**  
*Fits*  
**www.BestFitTruckParts.com**  
**855-220-8608**



## **H FUEL TANKS STRAPS** (cont.)

P/N 29-0601004

1.875" Stainless Steel Fuel Tank Strap w/Upper Step Bracket, For 63 Gallon D Tanks or 60 Gallon Rectangular Tanks, Replaces OE 417453C2, Fits 4700 & 4900 Series 1990-2002

P/N 29-0601013

1.875" Black Fuel Tank Strap w/o Step Brackets, For 63 Gallon D Tanks, Replaces OE 417453C2, Fits 4700 & 4900 Series 1990-2002, Pictured Below



## **FUEL TANKS**

P/N 29-06006001

60 Gallon 15" x 25" x 35" Aluminum, Rectangular Fuel Tank w/o Step, Replaces OE 576598C93, Fits 4700 & 4900 Series 1989-2001, Pictured Below



P/N 29-06006002

60 Gallon 15" x 25" x 35" Aluminum, Rectangular Fuel Tank w/Step, Fits Some Medium Duty & Ford Applications, Fits 4700 & 4900 Series 1989-2001, Pictured Below



P/N 29-06002800

28 Gallon 15" x 25" x 21" Aluminum, Rectangular Center Fill Fuel Tank, Fits 4700 Series 1995-2002, Fits 4900 Series 1995-2001, Pictured Below



## **I FRAME & CHASSIS**

P/N 07-051000

Rear Suspension Air Bag, Replaces OE 1R12-398, 1R12-538, 64263, 910-18.5P456, AB1DK23M-9648, AGAGA9648, PROAS9648, W01-358-9648, W01-500-9648, Fits 4700 & 4900 Series 1990-2001, Pictured Below



P/N 29-051021

Premium Poly Torque Rod Bushing Taper Stud Mount, 2.500" OD Outer Shell, 3.0" Taper Length, 1.250" x 12" Threads On End, Replaces OE 350015016, 44697000L, 29051021, 1693061C1, 35001-5016, 44697-000L, R302228, Fits 4700 & 4900 Series 1990-2001, Pictured Below



P/N 29-051023

Premium Poly Torque Rod Bushing, 2.500" OD Outer Shell, 2.625" Outer Shell Length, 4.375" C To C Of Bolt Holes, .625" ID Bolt Holes, 5.75" Overall Length, Replaces OE 44694000, 29051023, 151087148, 1693060C1, 350330088, 35033201, 44694-000L, 8079894, RB164, Fits 4700 & 4900 Series 1990-2001, Pictured Below



P/N 07-05095004

6 Leaf Front Spring, 3", Replaces OE 1661421C91, Fits 2002-Current, Pictured Below



P/N 07-051037

Rear Suspension Lower Shock Bracket, 4.1" Width, .25", .67" Hole, 6.9" From Bracket To Center Hole, .525" Center Hole, 3" Bottom Width, Fits 2002-Current, Pictured Below



P/N 07-051005

Front Of Rear Shackle Hanger, 13.625", 8.812", 2.438", .827", 5.7", .85", Replaces OE 3544131C2, Fits 2002-Current, Pictured Below



P/N 07-051011 (Left)

P/N 07-051012 (Right)

2 Leaf Air Beam Spring, Standard (S.E./L.E.) Spring Eye, 3" Width, S.E. (A) 25-.25, L.E. (B) 19-.5, Bushing A End (S.E.) Rb268, Mr782, Bushing B End (L.E.) M8-3630, Arch (C) 1-.5, Replaces OE 3544144C94, 3544144C95, 3544144C96, 3544144C97, Fits 2002-Current, Pictured Below



## **J FENDERS & RELATED**

P/N 09-11030600

Stainless Steel Quarter Fenders w/Full Braces, 22" Height x 25" Wide, 13.5" From Bottom To Center Of Mount, Fits 4700 & 4900 Series 1990-2001, Sold As A Pair, Pictured Below



P/N 09-11050602

Black Poly Quarter Fenders, Fits 4700 & 4900 Series 1990-2001, Sold As A Pair, Pictured Below



## **K WHEELS & ACCESSORIES**

P/N 09-20132231 (22.5")

P/N 09-20132431 (24.5")

Accuride Aluminum Wheel, Steer/Drive, Pictured Below



P/N 09-2015221 (22.5")

P/N 09-2015241 (24.5")

White Steel Wheel, 10 Hole Hub, Steer/Drive, Pictured Below



\*\*\* High Quality Aftermarket Replacement Part (Not OEM Parts).

All items represented are aftermarket replacement parts. If you require OEM parts, please contact your nearest authorized International dealer. Four State Trucks is not affiliated with Navistar.

# AFTERMARKET COLLISION PARTS

## EXHAUST PARTS FOR INTERNATIONAL 4900, 1995-2005

- N/A** 3.5" TURBO V-BAND CLAMP,  
*Replaces OE 893944R92,  
3553803C2, Fits 2002-2007*
- 1** P/N 07-08145040  
Turbo Multi Bend Pipe,  
*Replaces OE 2004504C1*
- 2** P/N 09-0800070  
3.5" Stainless Steel Flat Band Clamp,  
*Replaces OE 583977C91, Fits 4700 &  
4900 Series 1995-2001*
- 3** P/N 07-08145350  
Multi Bend Inlet Pipe, *Replaces OE  
2004535C2, Fits 4700 & 4900 Series  
1995-2001*
- 4** P/N 07-08499220  
Muffler Mount Strap, *Replaces OE  
2029922C91, Fits 4700 & 4900 Series  
1995-2001*
- 5** P/N 07-080201  
3.5" I.D. x 4" Dia. Muffler, *Replaces OE  
2018471C1, Fits 4700 & 4900 Series  
1995-2001*
- 6** P/N 09-0800050  
4" Stainless Steel, Non-Polished  
Flat Band Clamp, *Replaces OE  
2015639C1, Fits 4700 & 4900 Series  
1995-2001*
- 7** P/N 09-0801405  
4" Muffler Outlet Pipe, *Replaces OE  
258387C2, Fits 4700 & 4900 Series  
1995-2001*

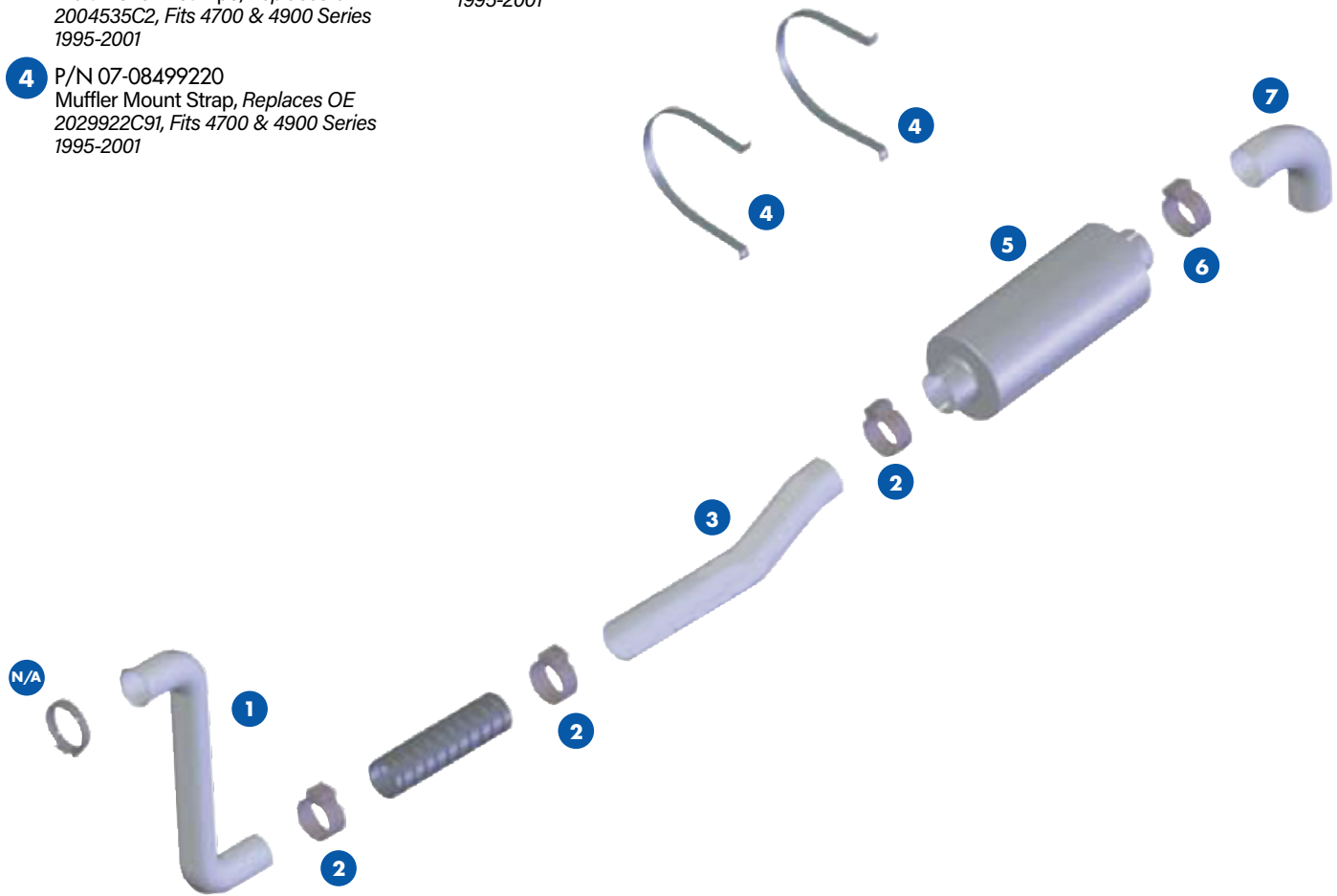

\*\*\* High Quality Aftermarket Replacement Part (Not OEM Parts).

All items represented are aftermarket replacement parts. If you require OEM parts, please contact your nearest authorized International dealer. Four State Trucks is not affiliated with Navistar.