

# AFTERMARKET COLLISION PARTS

FITS PETERBILT 359

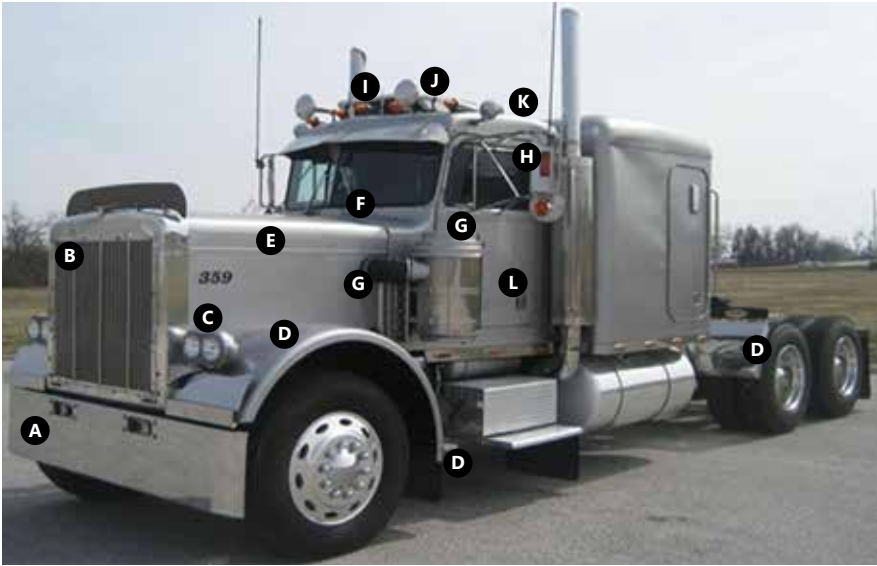

## A BUMPERS

P/N HA001002

16" Chrome Bumper w/Tow Holes, Standard, Fits 1967-1986 359 Conventional & 1967-1980 352 COE

P/N HA001006

18" Chrome Texas Square Rolled End Bumper w/Tow Holes, Fits 1967-1986 359 Conventional & 1967-1980 352 COE

## B ENGINE COOLING PARTS

P/N 02-070605

Fiberglass Fan Shroud, Needs Modification To Fit, Replaces OE K216-1982

## C HEADLIGHT & TURN SIGNALS

P/N 09-1606163 (Left)

P/N 09-1606164 (Right)

Polished Stainless Steel Dual Round Headlight Assembly w/Halogen Head Lamps

P/N 01-1606008

Headlight Mounting Bracket

P/N 09-1606051

Dual Round Headlight Bucket Assembly

## D FENDERS & RELATED

P/N 01-12717 (Left)

P/N 01-12718 (Right)

Aftermarket Aluminum Front Fenders, Replaces OE 15-04540M000L, 15-04540M000R, OEM Part Not An Aftermarket Part

P/N 01-12601

Chrome Fender Step, Sold As A Pair

P/N 09-11050602

Black Poly Quarter Fenders, Sold As A Pair

P/N 09-110306041

24" Stainless Steel Quarter Fender w/Tube, Mounts To Standard Post, Post Not Included, Sold As A Pair

P/N 09-11030600

Stainless Steel Quarter Fenders w/Full Braces, 22" Height x 25" Wide, 13.5" From Bottom To Center Of Mount, Sold As A Pair

## E HOODS & RELATED

P/N 01-12445 (Left)

P/N 01-12446 (Right)

Aftermarket Top Hood Panel, For Long Hood, Replaces OE 13-03467L, 13-03467R, Fits 1972-1986

P/N 01-12447 (Left)

P/N 01-12448 (Right)

Aftermarket Side Hood Panel, For Long Hood, Replaces OE 13-03463, Fits 1972-1986

P/N 01-12451

Aftermarket Hood Cylinder w/Quick Release Shuttle Valve, Orifice Plug & .375 Ball Joint End, Corrosion Resistant Hard Coated Anodized Aluminum Tubes, Must Spray To Break Seals In Properly, Replace As A Pair, Replaces OE 349100, Pictured Below



P/N 01-12409

Hood Hinge Repair Kit, 1 Kit Per Hinge, Replaces OE 13-03318, Fits 1972-1987

P/N 01-12400

Hood Cone Support Kit, Includes Hood Rest, Mount Bushings Sleeve & Washer Nuts, Replaces OE 13-01840

P/N 01-12429

Hood Cone Support, Red Poly, Replaces OE 13-04609

P/N 01-12401

Upper Hood Rest, Black Poly Center, Replaces OE 13-030114

P/N 01-12404

Small Hood Roller, 1.375" O.D., .375" I.D., 1.625" Length, Replaces OE 13-03440

P/N 01-12405

Large Hood Roller, 2" O.D., .375" I.D., 1.5" Length, Replaces OE 13-03439

P/N 01-12430

Hood Guide Grommet, Black Poly, Replaces OE 13-03170, 13-03425

## F WINDSHIELD WIPERS

P/N 01-0911006

Windshield Wiper Conversion Kit, Converts Air To Electric, For Peterbilt 359, Complete Kit w/Washer Reservoir

## G AIR CLEANERS

P/N 09-090515001

15" Air Cleaner, Vortex Style w/Stainless Steel Housing & Oblong Holes On Screen, Single Bolt, Filter Element Not Included

P/N 01-090550

Intake Elbow, 68 Degree, Connects 7" O.D. To 6" O.D.

## H MIRRORS & RELATED

P/N 09-0915011

Stainless Steel Mirror Head

P/N 09-0915007

Heated Mirror Head

P/N 09-0915008

Heated/Lighted Mirror Head

P/N 09-0915006

Heated/Motorized Mirror Head

P/N 09-0915003

8.5" Spot Mirror, Center Stud

P/N 09-0915004

8.5" Spot Mirror, Offset Stud

P/N 01-091501

Stainless Steel Outer Mirror Bracket, For Door Mounted Mirrors, Fits 2004 & Older

## I CAB LIGHTS

P/N 09-1608077

Chrome Bullet Cab Light

## J AIR HORNS & RELATED

P/N 09-051325

30" Chrome Round Style Air Horn

## K SLEEPERS

P/N 01-091601

Custom 1 Piece Fiberglass Roof Cap For 48" Sleeper, Includes Aluminum Roof Support Bracing, Replaces 3 Piece Roof Cap

## L DOOR ACCESSORIES

P/N 01-0914078 (Left)

P/N 01-0914079 (Right)

Stainless Steel Exterior Door Handle, Replaces OE 20-08179L, 20-08179R, Fits 1973-2004

P/N 01-0914050 (Left)

P/N 01-0914051 (Left)

Stainless Steel Door Hinge, Does Not Have Notch At Top For Wire Boot

\*\*\*Prices are subject to change without notice.

\*\*\*\*High Quality Aftermarket Replacement Part (Not OEM Parts).

All items represented are aftermarket replacement parts. If you require OEM parts, please contact your nearest authorized Peterbilt dealer. Four State Trucks is not affiliated with Paccar or Peterbilt.

www.BestFitTruckParts.com  
855-220-8608

# AFTERMARKET COLLISION PARTS



## **M** TOOL BOXES

**P/N 01-05010231**

Complete Aluminum Battery Box, Old Style, Diamond Plate Top & Step, Smooth Aluminum Sides, *Pictured Below*



## **N** MUD FLAPS

**P/N 01-0507007**

24" x 18" Logo Mud Flap For Battery Box/Tool Box, *Replaces OE 1160B, Fits 1967-1987, OEM Part Not An Aftermarket Part*

**P/N 01-0507008**

24" x 14" Logo Mud Flap For Battery Box/Tool Box, *Replaces OE 1163B, MF0001, Fits 1967-1987, OEM Part Not An Aftermarket Part*

## **O** FUEL TANK ACCESSORIES

**P/N 29-0601008**

4" Fuel Tank Strap Rubber Liner w/Outside Lip, *Sold By The Foot*

**P/N 29-0601009**

4" Fuel Tank Strap Rubber Liner w/o Outside Lip, *Sold By The Foot*

**P/N 29-060313**

Adjustable Fuel Sender *Fits 6" to 27" DIA. Tanks, 240 to 33 OHM*

**P/N 29-060314**

.375" x 24" Steel Pick Up Tube, Cut To Fit Tank Depth, .5" Male Pipe Into Fuel Tank, .375" Female Pipe Thread In Top

**P/N 29-060317**

.5" x 28" Steel Pick Up Tube, Cut To Fit Tank Depth, .5" Male Pipe Into Fuel Tank, .5" Female Pipe Thread In Top

**P/N 01-060301**

Non-Locking Non-Vented Fuel Tank Cap w/Pressure Relief, *Fits 1985-1987*

**P/N 01-060303**

Locking Non-Vented Fuel Tank Cap w/Pressure Relief, *Fits 1985-1987*

**P/N 01-0601010**

4" Aftermarket Aluminum Satin Finish Fuel Tank Strap For 26" Dia. Fuel Tanks, Fuel Tank Strap Liner Sold Separately, *Replaces OE 11-03596, Fits 1972-1987, Pictured Below*



**P/N 01-0601011**

Aftermarket Fuel Tank Bracket For Upper Fuel Tank Mount, 26" Dia. Fuel Tank, *Fits 1972-1987, Pictured Below*



## **FUEL TANKS**

**P/N 01-06008001 (Left)**

**P/N 01-06008002 (Right)**

80 Gallon Aluminum Rear Fill Fuel Tank, 26" x 38", *Fits 1972-1987, Verify Which Style Manifold Tank Has*

**P/N 01-060010003 (Left)**

**P/N 01-060010004 (Right)**

100 Gallon Aluminum Rear Fill Fuel Tank, 26" x 48", *Fits 2006 & Older, Verify Which Style Manifold Tank Has*

**P/N 01-060012501 (Left)**

**P/N 01-060012502 (Right)**

125 Gallon Aluminum Rear Fill Fuel Tank, 26" x 57", *Fits 1972-1987, Verify Which Style Manifold Tank Has*

**P/N 01-060013501 (Left)**

**P/N 01-060013502 (Right)**

135 Gallon Aluminum Rear Fill Fuel Tank, 26" x 66", *Fits 2006 & Older, Verify Which Style Manifold Tank Has*

**P/N 01-060015001 (Left)**

**P/N 01-060015002 (Right)**

150 Gallon Aluminum Rear Fill Fuel Tank, 26" x 72", *Fits 2006 & Older, Verify Which Style Manifold Tank Has*

## **CAB ACCESSORIES**



**P** **P/N 01-1503002**

Chrome Round Defroster Vent

**Q** **P/N 01-1510502**

Fiberglass Dashboard Housing, *Replaces OE 20-10406*

**R** **P/N 01-151708**

Black Cab Carpet Kit, Includes Backing

**P/N 01-151709**

Black Vinyl Cab Floor Mat, Includes Backing

**P/N 01-1513007**

Black Rubber Shift Boot, *Replaces OE 20-02071, Pictured Below*



**P/N 01-1513003**

Shift Boot Trim Ring, *Replaces OE 20-01998, Fits 1973-1987, OEM Part Not An Aftermarket Part, Pictured Below*



\*\*\*Prices are subject to change without notice.

\*\*\*\*High Quality Aftermarket Replacement Part (Not OEM Parts).

All items represented are aftermarket replacement parts. If you require OEM parts, please contact your nearest authorized Peterbilt dealer. Four State Trucks is not affiliated with Paccar or Peterbilt.

# AFTERMARKET COLLISION PARTS

## EXHAUST PARTS FOR PETERBILT 359

- 1** P/N 09-08506001  
5" O.D. x 60" Turnout Chrome Top Stack,  
Other Sizes Available
- 2** P/N 09-0800009  
5" Stainless Steel Flat Band Clamp
- P/N 09-0800010  
5" Stainless Steel Preformed Band Clamp
- N/A** P/N 29-080839  
Stainless Steel Exhaust Shield, Includes  
Mount Brackets
- 3** P/N 29-080200  
5" I.D. x 10" Dia. Muffler
- 4** P/N 01-08117264  
Chrome Exhaust Elbow,  
Replaces OE 14-01726C
- 5** P/N 09-080451  
5" Stainless Steel Flex Pipe,  
Sold By The Foot
- 6** P/N 01-0806003  
Exhaust Y-Pipe, Replaces OE 14-04055
- 7** P/N 09-0801500  
5" Steel Exhaust Pipe, Sold By The Foot
- 8** P/N 01-08133940  
Down Pipe Elbow, Replaces OE 14-13394
- 9** P/N 01-08130020  
Turbo Pipe w/Pyro Hole, Replaces OE  
14-14-13002
- 10** P/N 29-080001  
5" Turbo V-Band Clamp

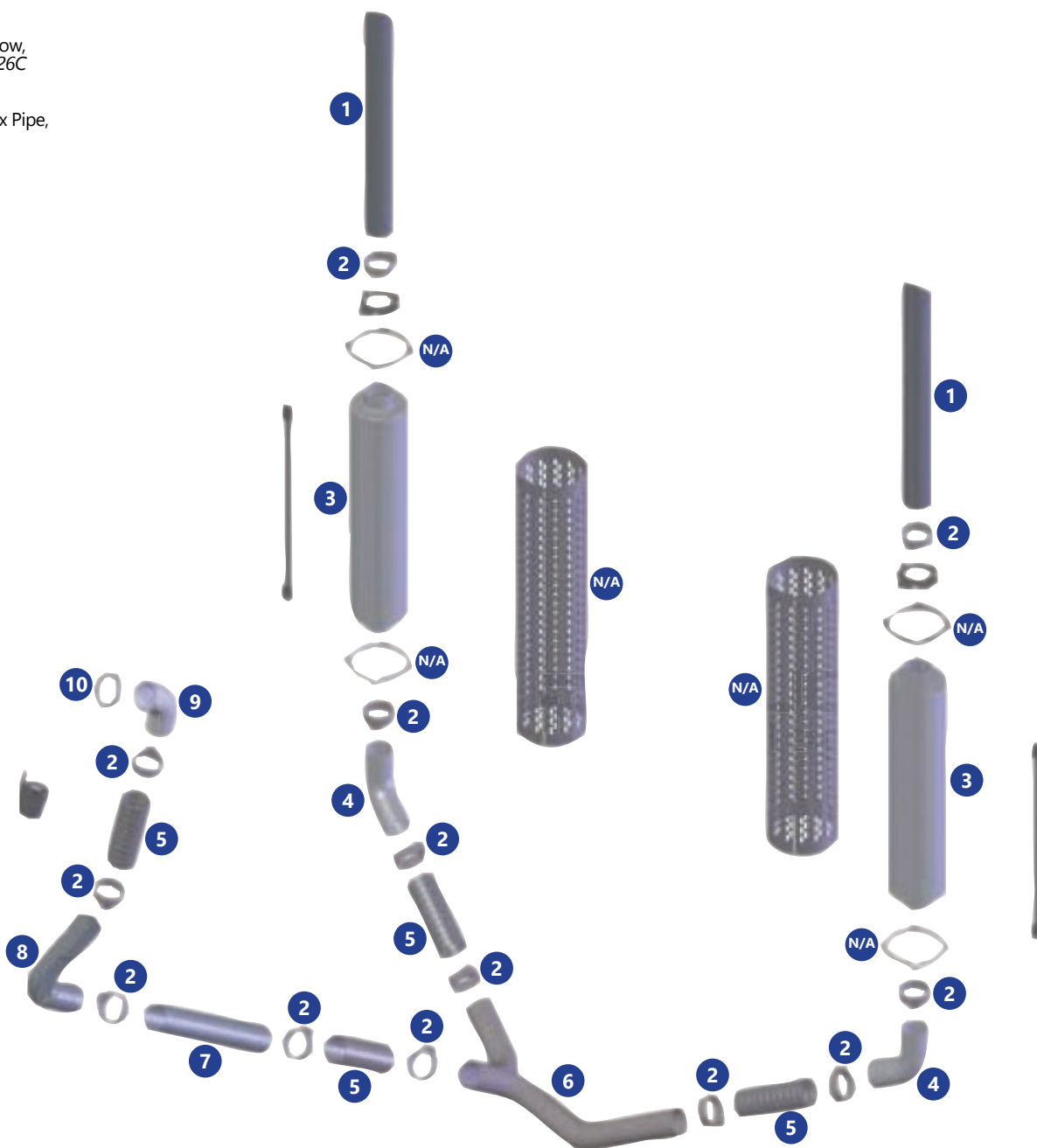

\*\*\*Prices are subject to change without notice.

\*\*\*\*High Quality Aftermarket Replacement Part (Not OEM Parts).

All items represented are aftermarket replacement parts. If you require OEM parts, please contact your nearest authorized Peterbilt dealer. Four State Trucks is not affiliated with Paccar or Peterbilt.

[www.BestFitTruckParts.com](http://www.BestFitTruckParts.com)  
855-220-8608

**FITS PETERBILT 359**