

AFTERMARKET COLLISION PARTS

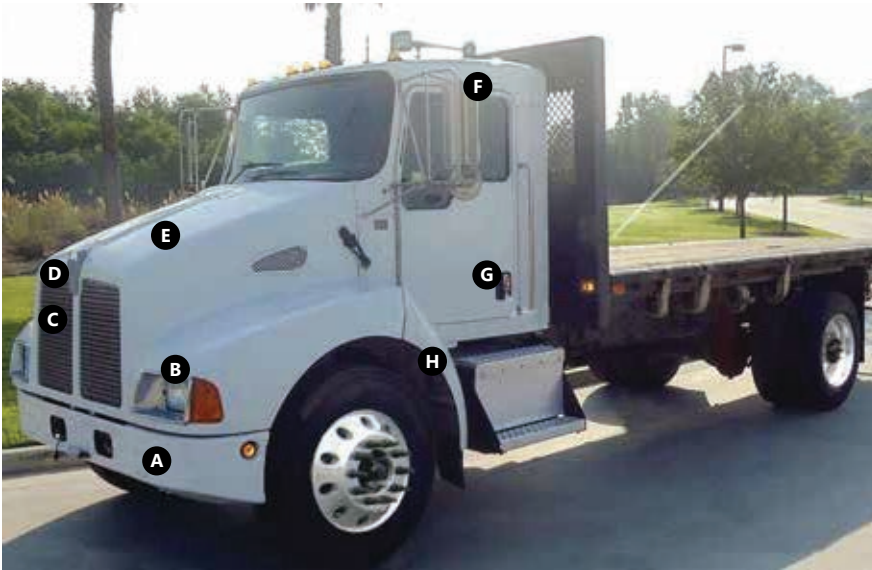

A BUMPERS

P/N FL001018
13" Chrome Set Forward Axle Bumper
w/Tow Holes

P/N 02-010104
13" Chrome Aero Bumper Fits 1994-2009

P/N 02-0104015 (Left)
P/N 02-0104016 (Right)
Aftermarket Fiberglass Replacement Bumper
w/Fiberglass Ends, Replaces OE K064-1523,
K064-1523R, Fits 1994-2007

B HEADLIGHTS & TURN SIGNALS

P/N 02-1606006 (Left)
P/N 02-1606008 (Right)
Chrome Headlight Bezel, Replaces OE
L18-1002, L18-1002R, Fits 1994-2008,
Pictured Below



02-1606008

02-1606006

P/N 29-1606017
7.5" x 5" Single Square Headlight Assembly,
Pictured Below



P/N 02-160701102 (Left)
P/N 02-160701103 (Right)
Turn Signal, Replaces OE P54-1038, P54-1038R,
Pictured Below



02-160701103

02-160701102

C ENGINE COOLING PARTS

P/N 02-070013
A/C Condenser, 16" Height, 30" Width, 1"
Thick, Replaces OE K122-128, Fits 1995-2001

P/N 29-070106
Charge Air Cooler, For Cummins, Replaces OE
K093-77, Fits 1995-2004

P/N 29-070100
Charge Air Cooler Hose & Clamp Kit,
Includes 2 Hoses & 4 Stainless Steel Clamps

P/N 02-070213
Radiator, For Cummins, 36.5" Height, 26"
Width, 2" Thick, 2.5" I.D., 2.5" O.D., Replaces
OE 1A020629, K194-1927-1, Fits 1995-2003

P/N 29-070207
Support Bushings, For Radiators w/ Bottom
Mounts, Contains 2 Bushing Halves & 1
Sleeve, Need 2 Per Truck, Replaces OE
07-03286, Will Not Fit Radiators w/Mounts In
The Cross Member Under The Radiator

ENGINE PARTS

P/N 02-070700
Washer Reservoir, Replaces OE K114-20,
Fits 1999-2002, Pictured Below



P/N 29-070700
Washer Reservoir Cap, Replaces OE C5720S,
Fits 1999-2002

D GRILLES

P/N 02-1210305
Aftermarket Grille, Aluminum Tube Style,
Replaces OE K137-300-1

P/N 02-1210407
Aftermarket Chrome Mesh Grille,
Replaces OE K137-300-1

E HOODS & RELATED

P/N 02-12500
Aftermarket Fiberglass Hood Shell,
Replaces OE K146-1193, Fits 1994-1996,
Must Change Hinges To Fit 1997-2003,
Must Use 1994-1996 Hinges

P/N 29-124000
Hood Latch Kit, Need 2 Per Truck,
Replaces OE L56-0001 Fits 1987-2007,
Pictured Below



P/N 02-124004
Hood Cone Support Bushing, Need 2 Per
Truck, Replaces OE K179-450

P/N 02-124007
Hood Roller, 1.125" O.D., .625" I.D., 1.5"
Length, Replaces OE K066-360

F MIRRORS & RELATED

P/N 09-0915011
Stainless Steel Mirror Head

P/N 09-0915007
Heated Mirror Head

P/N 09-0915006
Heated/Motorized Mirror Head

P/N 09-0915003
8.5" Spot Mirror, Center Stud

P/N 09-0915004
8.5" Spot Mirror, Offset Stud

P/N 02-091505
Stainless Steel Mirror Set, Fits 1994-2009,
Pictured Below



G DOOR ACCESSORIES

P/N 29-091402 (Left)
P/N 29-091403 (Right)
Exterior Door Handle, New Style, Replaces OE
R56-1025, R56-1025R, Fits 2003 & Newer

P/N 02-0914042 (Left)
P/N 02-0914043 (Right)
Stainless Steel Exterior Door Handles, Old
Style, Replaces OE K294-411PAK, K294-
411PAKR, Fits 2003 & Older

P/N 02-0914050 (Left)
P/N 02-0914051 (Right)
Exterior Door Handles, Old Style, Replaces OE
K294-194, K294-194R, Fits 1983-1996

P/N 02-1530044 (Left)
P/N 02-1530045 (Right)
Interior Door Handles, Replaces OE
K294-426PAK, K294-426RPAK,
Fits 1995-2001

H FENDER EXTENSIONS

P/N 02-0512030 (Left)
P/N 02-0512130 (Right)
Fender Extensions, Replaces OE K127-951,
K127-951R, Fits 1994-2003

***Prices are subject to change without notice.

****High Quality Aftermarket Replacement Part (Not OEM Parts).

All items represented are aftermarket replacement parts. If you require
OEM parts, please contact your nearest authorized Kenworth dealer.
Four State Trucks is not affiliated with Paccar or Kenworth.

FITS KENWORTH T300

www.BestFitTruckParts.com
855-220-8608

AFTERMARKET COLLISION PARTS



I WHEELS & ACCESSORIES

P/N 09-20132231
22.5" Accuride Aluminum Wheel, Steer/Drive

P/N 09-20132431
24.5" Accuride Aluminum Wheel, Steer/Drive

J FUEL TANK ACCESSORIES

P/N 09-060101
2" Wide Rubber Fuel Tank Strap Liner
w/Lip, Sold By the Foot, Pictured Below



P/N 09-060302
Safety Vent 1/2" Thread, Fits 1984-2006

P/N 09-060303
Safety Vent 1/4" Thread

P/N 02-060306
Fuel Sender, For 24.5" Dia. Tank, Has OE
Style Plug, Replaces OE Q21-1024-622,
Fits 1987-2011, Pictured Below



P/N 02-060307
Fuel Sender, For 22" Dia. Tank, Has OE Style
Plug, Replaces OE Q21-1024-559,
Fits 1987-2011

P/N 29-060313
Adjustable Fuel Sender Fits 6" to 27" DIA.
Tanks, 240 to 33 OHM, Pictured Below



P/N 29-060304
Return High Flow Fuel Splitter

P/N 29-060306
Anti-Siphon Tube Insert

P/N 02-0601000
2" Aftermarket Stainless Steel Fuel Tank
Strap, Fits 24.5" Dia. Tanks w/Steps,
Has 7/16" Thread On Stem, Use Nut 37373,
Pictured Below



P/N 02-0601001
2" Aftermarket Stainless Steel Fuel Tank
Strap, Fits 24.5" Dia. Tanks w/o Steps,
Has 7/16" Thread On Stem, Use Nut 37373

P/N 02-0601007
Fuel Tank Strap Bracket, Fits To Bottom Of
Lower J Bracket For Strap To Mount Through

P/N 02-060300
Non-Locking, Vented Fuel Tank Cap,
Pictured Below



P/N 02-060301
Locking, Vented Fuel Tank Cap

FUEL TANKS

P/N 02-06006001K (Left)
P/N 02-06006002K (Right)
60 Gallon Aluminum Front Fill Fuel Tank,
22" x 34", Fits 2008 & Newer

P/N 02-06006001 (Left)
P/N 02-06006002 (Right)
60 Gallon Aluminum Front Fill Fuel Tank,
22" x 34", Fits 2007 & Older

P/N 02-06007001K (Left)
P/N 02-06007002K (Right)
70 Gallon Aluminum Rear Fill Fuel Tank,
24.5" x 36", Fits 2008 & Newer

P/N 02-06007001 (Left)
P/N 02-06007002 (Right)
70 Gallon Aluminum Front Fill Fuel Tank,
24.5" x 36", Fits 2007 & Older

P/N 02-060010007K (Left)
P/N 02-060010008K (Right)
100 Gallon Aluminum Rear Fill Fuel Tank,
22" x 60", Filler Tube Cut To Length,
Fits 2008 & Newer

P/N 02-060010007 (Left)
P/N 02-060010008 (Right)
100 Gallon Aluminum Rear Fill Fuel Tank,
22" x 60", Filler Tube Cut To Length,
Fits 2007 & Older

***Prices are subject to change without notice.
****High Quality Aftermarket Replacement Part (Not OEM Parts).
All items represented are aftermarket replacement parts. If you
require OEM parts, please contact your nearest authorized Kenworth
dealer. Four State Trucks is not affiliated with Paccar or Kenworth.

AFTERMARKET COLLISION PARTS

EXHAUST PARTS FOR KENWORTH T300, CUMMINS ENGINE, 2002-2006

- N/A** 4" EXHAUST V-BAND CLAMP AT TURBO,
Replaces OE 100280-3, Fits 2002-2006
- N/A** 4" EXHAUST PIPE MOUNT BRACKETS,
Replaces OE K077-100, Fits 2000-2006
- 1** P/N 02-08196530
4" Multi Bend Turbo Pipe,
Replaces OE K180-19653, Fits 2002-2006
- 2** P/N 02-08188200
4" Exhaust Down Pipe,
Replaces OE K180-18820
- 3** P/N 09-0800050
4" Stainless Steel, Non-Polished Flat Band Clamp, *Replaces OE 2015639C1*
- 4** P/N 09-080441
4" Stainless Steel Flex Pipe,
Sold By The Foot
- 5** P/N 02-08145180
4" Exhaust Intermediate Pipe,
Replaces OE K180-7345-18
- 6** P/N 02-08414600
Exhaust Muffler Mount Straps,
Replaces OE K231-460
- 7** P/N 29-080208
4" O.D. x 4" I.D. Muffler,
Replaces OE M11-0318
- 8** P/N 09-0801405
Aftermarket Universal 4" Plain Exhaust Tail Pipe, 90 Degree, *Replaces OE K180-1741-6, P180-17605, Fits 1994-2008*

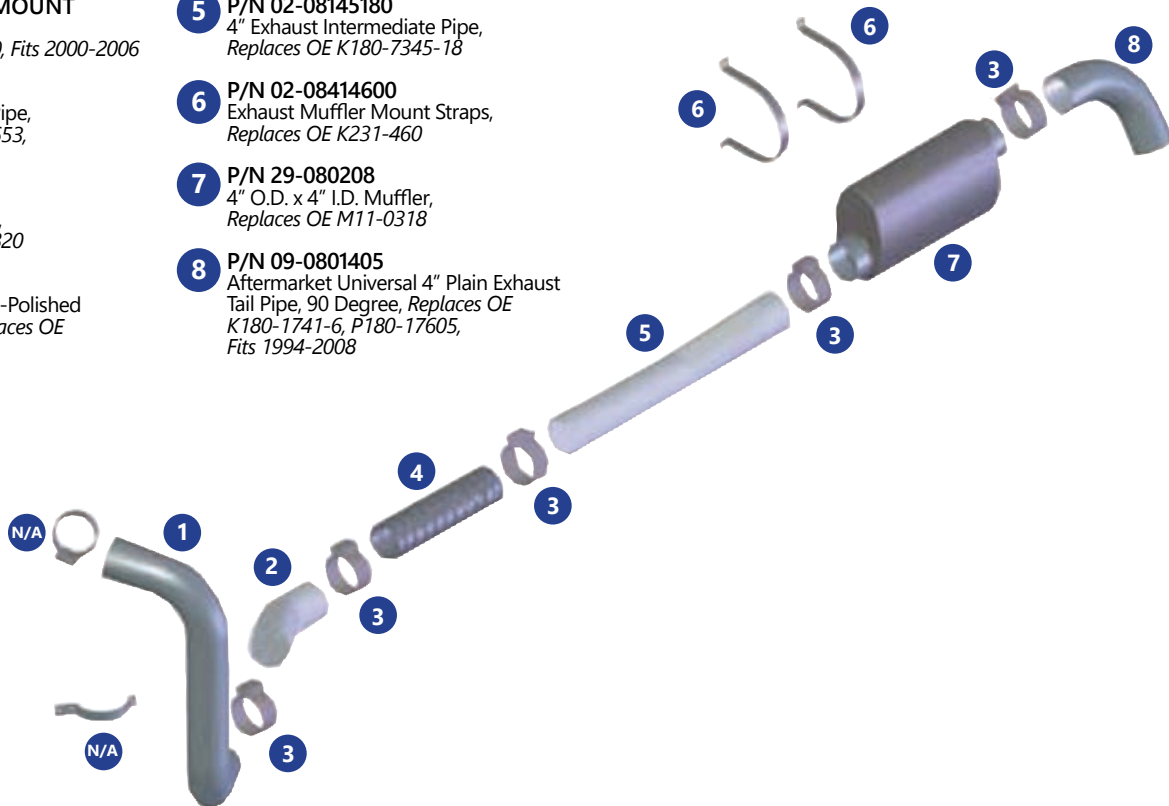

EXHAUST PARTS FOR KENWORTH T300, UNDER TRUCK EXHAUST, 2000-2004

- 1** P/N 29-080004
4" Exhaust V-Band Clamp At Turbo,
Replaces OE 100280-6, Fits 2002-2006
- N/A** 4" EXHAUST PIPE MOUNT BRACKETS,
Replaces OE K077-100, Fits 2000-2006
- N/A** 4" MULTI BEND TURBO PIPE
Replaces OE M66-1426, Fits 2002-2006
- 2** P/N 09-080441
4" Stainless Steel Flex Pipe,
Sold By The Foot
- 3** P/N 09-0800050
4" Stainless Steel, Non-Polished Flat Band Clamp, *Replaces OE 2015639C1*
- 4** P/N 02-08114180
4" Multi Bend Intermediate Pipe,
Replaces OE M66-1418
- 5** P/N 02-08429150
Exhaust Muffler Mount Brackets,
Replaces OE K054-2915
- 6** P/N 02-08414600
Exhaust Muffler Mount Straps,
Replaces OE K231-460
- 7** P/N 09-0801405
Aftermarket Universal 4" Plain Exhaust Tail Pipe, 90 Degree, *Replaces OE K180-1741-6, P180-17605, Fits 1994-2008*

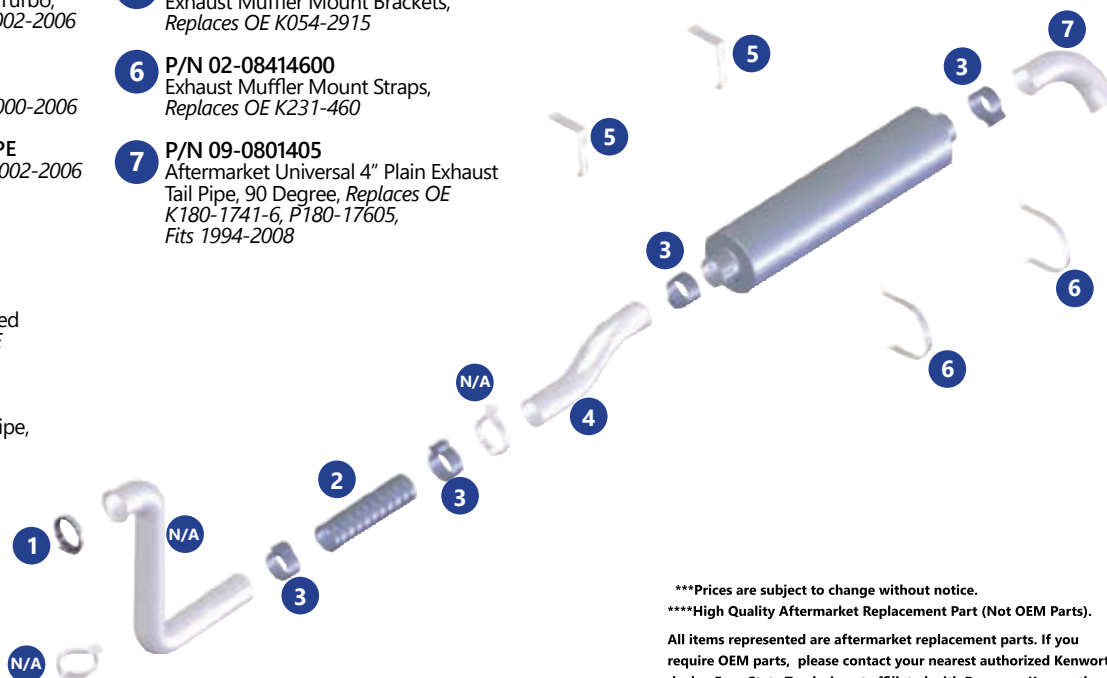

FITS KENWORTH T300

**www.BestFitTruckParts.com
855-220-8608**

***Prices are subject to change without notice.

****High Quality Aftermarket Replacement Part (Not OEM Parts).

All items represented are aftermarket replacement parts. If you require OEM parts, please contact your nearest authorized Kenworth dealer. Four State Trucks is not affiliated with Paccar or Kenworth.

AFTERMARKET COLLISION PARTS

EXHAUST PARTS FOR KENWORTH T300, ON CAB EXHAUST, 2002-2006

- 1** P/N 29-080004
4" Exhaust V-Band Clamp At Turbo,
Replaces OE 100280-6, Fits 2002-2006
- 2** P/N 02-08114100
4" Exhaust Turbo Pipe, 90 Degree,
Replaces OE M66-1410, Fits 2002-2006
- N/A** 4" EXHAUST V-BAND CLAMP
AT TURBO,
Replaces OE 100280-3, Fits 2002-2006
- N/A** 4" EXHAUST DOWN PIPE,
90 Degree, *Replaces OE M66-1411, Fits
2002-2006*
- N/A** 4" EXHAUST PIPE MOUNT
BRACKETS,
Replaces OE K077-100, Fits 2000-2006
- 3** P/N 09-080441
4" Stainless Steel Flex Pipe,
Sold By The Foot
- 4** P/N 09-0800050
4" Stainless Steel, Non-Polished
Flat Band Clamp, *Replaces OE
2015639C1*
- 5** P/N 02-08412490
Exhaust Pipe Mount Brackets,
Replaces OE M11-1249, Fits 2000-2006
- 6** P/N 02-08102500
4" Exhaust Elbow Below BOM Elbow,
90 Degree, *Replaces OE
K180-19878-0800-250 Fits 2002-2006*
- N/A** 4" CHROME EXHAUST
MULTI BEND ELBOW BOM,
*Replaces OE M66-1444CP,
Fits 2000-2006*
- 7** P/N 09-0805001
5" Guillotine U Bolt Plain
Exhaust Clamp
- 8** P/N 09-08503607
5" O.D. x 36" Turnout Chrome Top
Stack, *Replaces OE K180-1096-36CP*
- 9** P/N 02-0808015
Lower Exhaust Shield & Muffler
Mounting Clamp, *Replaces OE
M16-1022, Fits 2002-2006*
- 10** P/N 02-0808014
Exhaust Shield Mounting Clamp,
Replaces OE M16-1021, Fits 2002-2006
- N/A** EXHAUST SHIELD
Replaces OE M46-1006, Fits 2002-2006

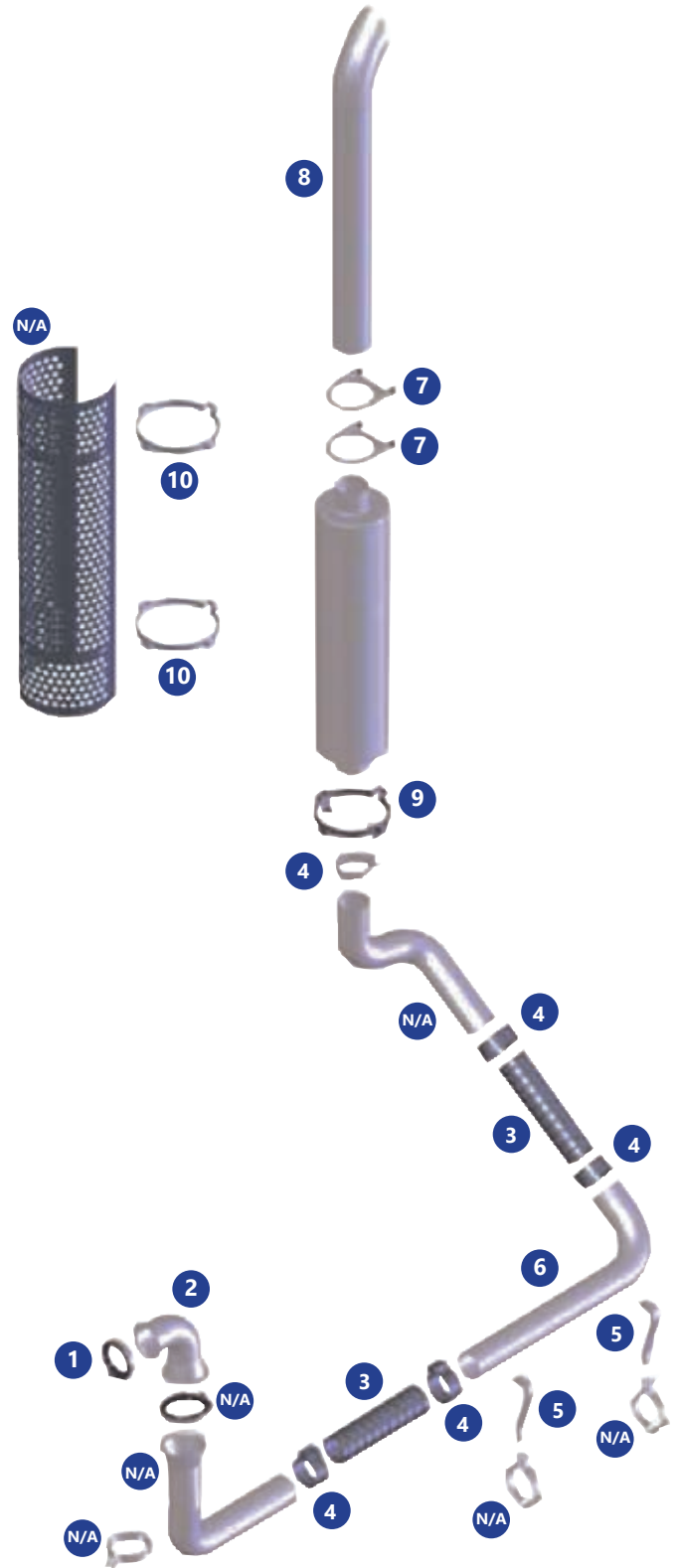

***Prices are subject to change without notice.
****High Quality Aftermarket Replacement Part (Not OEM Parts).
All items represented are aftermarket replacement parts. If you require OEM parts, please contact your nearest authorized Kenworth dealer. Four State Trucks is not affiliated with Paccar or Kenworth.