

AFTERMARKET COLLISION PARTS



A BUMPERS

P/N HUSP

4" Stainless Bumper Spoiler, Bumper Not Included, Fits 2006-2010, Pictured Below



P/N HU001016

16" Chrome Wrap Around Set Back Axle Bumper w/Tow Holes, Brackets Included, Replaces OE 15-06485F2000, Fits 2006-2012

P/N HU001016S

16" Stainless Steel Wrap Around Set Back Axle Bumper w/Tow Holes, Brackets Included, Replaces OE 15-06485F2000, Fits 2006-2012, Pictured Below

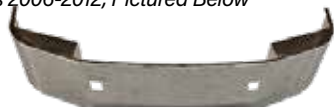

More Bumpers Are Available - Please Call!

B HEADLIGHTS & TURN SIGNALS

P/N 01-1606024 (Left)

P/N 01-1606025 (Right)

Headlight Assembly, Plug In, Easy To Install, Replaces OE 16-09190L & 160-09190R, Fits 2006-2016, Pictured Below



P/N 01-1606044 (Left)

P/N 01-1606045 (Right)

Chrome Projection Headlight Assembly, Plug In, Easy To Install, Replaces OE 16-09190L & 160-09190R, Fits 2006-2016, Pictured Below



P/N 01-1606048 (Left)

P/N 01-1606049 (Right)

Blackout Projection Headlight Assembly, Plug In, Easy To Install, Replaces OE 16-09190L & 160-09190R, Fits 2006-2016



C ENGINE COOLING PARTS AC CONDENSERS

P/N 01-070004

AC Condenser, Replaces OE R0337001, Fits 2008-2014, Pictured Below



CHARGE AIR COOLERS

P/N 29-070105

Charge Air Cooler For ISX Cummins, Replaces OE N4404001, Fits 2008-2014, Pictured Below



P/N 29-070100

Charge Air Cooler Hose & Clamp, Includes (2) 4" Hoses & (4) Stainless Clamps, Fits 1987-2007

PTR RADIATOR

P/N 29-070223

Radiator For ISX Cummins, 36.75" Width, 36" Height, 2" Thick, 2.5" I.D., 2.5" O.D., Replaces OE N4028001, Fits 2008-2014, Pictured Below



COOLANT RESERVOIR & RELATED

P/N 29-070203

Plastic Coolant Reservoir w/Cap & Level Sensor For Cummins Or CAT Engines w/Behr Cooling Module, Replaces OE N5346001, 575.1023, 5751023, 603-5403, 6035403, Fits 2008-2016, Pictured Below



P/N 29-0702113

Plastic Coolant Reservoir w/Sensor & Cap & Large Flow Port, Replaces OE T1673008, Fits 2008-2015, Pictured Below



P/N 01-070256

Coolant Reservoir Surge Tank w/Tank, .25" Fitting, 13.50" Tall, .5" NPT Fitting, .75" NPT Fitting, Replaces OE F86-6064, Fits 2008-2013, Pictured Below



P/N 29-070206

Coolant Reservoir Cap w/o Nipple, Replaces OE RC0050, Fits 2008-2013

P/N 29-070205

Coolant Reservoir Cap w/Nipple, Replaces OE N5348001, Fits 2008-2013

ENGINE PARTS

P/N 29-070702

Washer Reservoir For Cummins or CAT w/Behr Cooling Module, Replaces OE N5355001, Fits 2008-2010, Pictured Below



P/N 29-070700

Washer Reservoir Cap, Replaces OE C5720S

P/N 29-071694153

Flywheel Housing, Fits CAT C15, Replaces OE 1694153, 2234739, Fits 2000-2007

P/N 29-073680063

Flywheel Housing, Fits Cummins ISX, Replaces OE 3102196, 3103584, Fits 2001-2007, Pictured Below



P/N 09-071601428

Oil Pan Front/Rear Sump, C15 CAT, Replaces OE 1601428, 2263004, Fits 2000-2007

P/N 29-074952540

Oil Pan Front/Rear Sump, ISX Cummins, Replaces OE 3680530, 3680531, Fits 2000-2007, Pictured Below



D GRILLES & RELATED

P/N 01-1210029

Stainless Punched Grille Insert w/.25" Circles, Surround Not Included, Fits 2006-2015, Pictured Below



*** High Quality Aftermarket Replacement Part (Not OEM Parts).

All items represented are aftermarket replacement parts. If you require OEM parts, please contact your nearest authorized Peterbilt dealer. Four State Trucks is not affiliated with Paccar or Peterbilt.

AFTERMARKET COLLISION PARTS



D GRILLES & RELATED (cont.) STANDARD GRILLE GUARDS

P/N 01-01302K

Stainless Standard Grille Guard, Heavy-Duty 3" Tubes, Easy Installation No Drilling Or Front-End Modification, Steel Mounting Brackets Included, Folds Down For Easy Access To Hood, Mounts To Existing Bumper, *Fits 2006-2016, Pictured Below*



P/N 01-01306K

Black Powder Coated Stainless Standard Grille Guard, Heavy-Duty 3" Tubes, Easy Installation No Drilling Or Front-End Modification, Steel Mounting Brackets Included, Folds Down For Easy Access To Hood, Mounts To Existing Bumper, *Fits 2006-2016, Pictured Below*



DELUXE GRILLE GUARDS

P/N 01-01303K

Stainless Deluxe Grille Guard, Heavy-Duty 3" Tubes, Easy Installation No Drilling Or Front-End Modification, Steel Mounting Brackets Included, Folds Down For Easy Access To Hood, Mounts To Existing Bumper, *Fits 2006-2016, Pictured Below*



01-01307K

Black Powder Coated Stainless Deluxe Grille Guard, Heavy-Duty 3" Tubes, Easy Installation No Drilling Or Front-End Modification, Steel Mounting Brackets Included, Folds Down For Easy Access To Hood, Mounts To Existing Bumper, *Fits 2006-2016, Pictured Below*



HERD AERO 2 & 4 POST GRILLE GUARDS

P/N 01-01325 (2 Uprights, Horizontal 3" Tubes)

P/N 01-013000018 (4 Uprights, Horizontal, 3" Tubes)
Herd Aero Grille Guard, Mirror Polish Finish Aluminum, Fully Boxed-In Uprights, 18" Extruded Aluminum Bumper, 3" Tubes, 2 Eyebolts, Side & Center Lower Rake, Impact Plates, Light Mounting Tabs, *Fits 2006-2014, Pictured Below*



P/N 01-013000154 (2 Uprights, Horizontal 3" Tubes)

P/N 01-013000155 (4 Uprights, Horizontal, 3" Tubes)
Herd Aero Grille Guard w/Slam Latch & Lift Assist, Mirror Polish Finish Aluminum, Fully Boxed-In Uprights, 18" Extruded Aluminum Bumper, 3" Tubes, Side & Center Lower Rake, Impact Plates, Light Mounting Tabs, *Fits 2006-2014, Pictured Below*



HERD DEFENDER 2 & 4 POST GRILLE GUARDS

P/N 01-013000019 (2 Uprights, Horizontal 3" Tubes)

P/N 01-013000020 (4 Uprights, Horizontal, 3" Tubes)
Herd Defender Grille Guard, Mirror Polish Finish Aluminum, Fully Boxed-In Uprights, 12" Extruded Aluminum Bumper, 3" Tubes, 2 Eyebolts, Side & Center Lower Rake, Impact Plates, Light Mounting Tabs, *Fits 2006-2014, Pictured Below*



*** High Quality Aftermarket Replacement Part (Not OEM Parts).

All items represented are aftermarket replacement parts. If you require OEM parts, please contact your nearest authorized Peterbilt dealer. Four State Trucks is not affiliated with Paccar or Peterbilt.

P/N 01-013000156 (2 Uprights, Horizontal 3" Tubes)
P/N 01-013000157 (4 Uprights, Horizontal, 3" Tubes)
Herd Defender Grille Guard w/Slam Latch & Lift Assist, Mirror Polish Finish Aluminum, Fully Boxed-In Uprights, 12" Extruded Aluminum Bumper, 3" Tubes, Side & Center Lower Rake, Impact Plates, Light Mounting Tabs, *Fits 2006-2014, Pictured Below*



HERD ROAD TRAIN & SUPER ROAD TRAIN 4 POST GRILLE GUARDS

P/N 01-013000021 (4 Uprights, Horizontal 3" Tubes)

P/N 01-01328 (4 Uprights, Horizontal, 4" Tubes)
Herd Defender Grille Guard, Mirror Polish Finish Aluminum, Fully Boxed-In Uprights, 18" Extruded Aluminum Bumper, 3" Tubes, 2 Eyebolts, Side & Center Baluster Reinforced Lower Rake Eyebolts, Impact Plates, Light Mounting Tabs, *Fits 2006-2014, Pictured Below*



P/N 01-013000158 (4 Uprights, Horizontal 3" Tubes)

P/N 01-013000159 (4 Uprights, Horizontal, 4" Tubes)
Herd Defender Grille Guard w/Slam Latch & Lift Assist, Mirror Polish Finish Aluminum, Fully Boxed-In Uprights, 18" Extruded Aluminum Bumper, 3" Tubes, Side & Center Baluster Reinforced Lower Rake Eyebolts, Impact Plates, Light Mounting Tabs, *Fits 2006-2014, Pictured Below*



P/N 29-013000008 (3.5" License Plate Holder)
Herd GG-200 Series Grille Guard, Mirror Polish Finish, Tapered Box Uprights, 2.667" Top Tubes, 3.5" Lower Tubes, Towing Provision, Gussets For Extra Strength, No Rattle Latch, *Fits 2008-Current, Pictured Below*



E HOODS & RELATED

P/N 01-12514

Fiberglass Hood Shell w/65" Center Line For Set Back Axle, Hardware Not Included, *Replaces OE L29-6036, L29-6039, L29-6094-10010, L29-6184-20000, Fits 2006-2016, Pictured Below*



P/N 29-124001

Hood Latch Kit, Need 2 Per Truck, *Replaces OE 37-41-295-60, 37-99-344*

P/N 01-124005

Hood Cable, 34.47" Length, *Replaces OE L92-6017-0875, Fits 2006-2014*



E HOODS & RELATED (cont.)

P/N 01-124009
Hood Spring, 27.75" Overall, 15" Spring, .2" Hook Length, 1.562" Dia.

P/N 01-12483 (Left)
P/N 01-12484 (Right)
Hood Pivot Assembly Kit, Kit Includes Hood Pivot Spacer, Bracket, Bushing, Lower Hood Pivot, .5" x 1.75" Fender Washer, 12MM Nylon Nut, Hood Pivot Bolt, Replaces OE L48-0653, L48-0654, Fits 2006-2016

P/N 01-122003
Stainless Steel Air Intake Screen w/.4375" Circle Holes, Pictured Below



P/N 09-0915057
Stainless Pod Hood Mount Mirror Kit, Aerodynamic Design, 8.5" Convex Mirror, (4) .25" Mounting Studs, Bracket Included, For Driver Or Passenger Side, Replaces OE MX1-917SSA, 877, Fits 2006-2016, Pictured Below



P/N 09-0915058
Stainless Short Adjustable Tripod Hood Mirror, 8.5" Convex Mirror, 21"-32.75", Brackets Included, For Driver Or Passenger Side, Fits 2006-2016

BUG SHIELDS

P/N 01-12247
Aeroshield II Bug Shield, .1875" Thick Smoke Finished Polycarbonate Set In A Heavy-Duty Aluminum Extrusion w/Polished End Caps, Fits 2006-2015, Pictured Below



P/N 01-12221
Stainless Sloped Aero Style Bug Shield, Mounts Behind Grille Surround, Fits 2006-2016, Pictured Below



F CAB & RELATED CAB LIGHTS

P/N 09-1608078
Square Incandescent Cab Light, Grakon Style

AIR HORNS & RELATED

P/N 09-051327
25" Chrome Air Horn, Square, Hadley Style

P/N 09-051333
29" Chrome Air Horn, Square, Hadley Style

SUN VISORS

P/N 01-09003060
11" Aftermarket Stainless Steel Ultra Flat Top Blind Mount Drop Visor, For Door Or Cab Mounted Mirrors, Fits 1987-2014, Pictured Below



MIRRORS & RELATED

P/N 09-0915011
Stainless Steel Mirror Head, Pictured Below



P/N 09-0915007
Heated Mirror Head

P/N 09-0915008
Heated/Lighted Mirror Head

P/N 09-0915006
Heated/Motorized Mirror Head, Pictured Below



P/N 09-0915003
8.5" Spot Mirror, Center Stud

P/N 09-0915004
8.5" Spot Mirror, Offset Stud

DOOR ACCESSORIES

P/N 29-091402 (Left)
P/N 29-091403 (Right)
Exterior Door Handle, New Style, Replaces OE R56-1025, R56-1025R, Fits 2006-2014, Pictured Below



G FUEL TANKS & RELATED FUEL TANK ACCESSORIES

P/N 29-0601008 (w/Outside Lip)
P/N 29-0601009 (w/o Outside Lip)
4" Fuel Tank Strap Rubber Liner, Sold By The Foot, Pictured Below



P/N 09-060302
Safety Vent .5" Thread, Fits 2006-2014

P/N 01-060302
Safety Vent 1.25" Thread, Fits 2006-2007

P/N 01-060304
Fuel Sender For 26" Dia. Fuel Tanks, Includes OE Style Plug, Replaces OE K21-6001-661, Fits 1987-2011, Pictured Below



P/N 01-060305
Fuel Sender For 23" Dia. Fuel Tanks, Includes OE Style Plug, Replaces OE K21-6001-585, Fits 1987-2011

P/N 29-060313
Adjustable Fuel Sender Fits 6" to 27" DIA. Tanks, 240 to 33 OHM, Pictured Below



P/N 29-060304
Return High Flow Fuel Splitter

FUEL TANK CAPS

P/N 01-060301
Non-Locking Non-Vented Fuel Tank Cap w/Pressure Relief, Fits 1985-1987, Pictured Below



P/N 01-060312
Locking Non-Vented Fuel Tank Cap w/Pressure Relief, Fits 1985-1987

*** High Quality Aftermarket Replacement Part (Not OEM Parts).

All items represented are aftermarket replacement parts. If you require OEM parts, please contact your nearest authorized Peterbilt dealer. Four State Trucks is not affiliated with Paccar or Peterbilt.

AFTERMARKET COLLISION PARTS



G FUEL TANKS & RELATED (cont.) **FUEL TANK CAPS**

P/N 29-060310

DEF Fluid Cap, Replaces OE 908-0223-01, Fits 2010 & Newer, Pictured Below



FUEL TANK STRAPS

P/N 01-0601010

P/N 01-0601011 (Bracket Only)
4" Aftermarket Non-Polished Aluminum Fuel Tank Strap For 26" Dia. Tanks, Will Fit Stock Tank Brackets, Strap Liner, Sold Separately, Replaces OE 11-03596, Fits 2006-2010, Pictured Below



P/N 01-0601024

4" Aftermarket Non-Polished Stainless Fuel Tank Strap For 26" Dia. Fuel Tanks, Will Fit Stock Tank Brackets, Strap Liner Sold Separately, Fits 2006-2016, Pictured Below



P/N 01-0601016

4" Aftermarket Polished Aluminum Fuel Tank Strap For 23" Dia. Fuel Tanks, Will Fit Stock Tank Brackets, Strap Liner, Sold Separately, Replaces OE 11-03595, Fits 2006-2014, Pictured Below



FUEL TANKS

P/N 01-060010003 (Left)

P/N 01-060010004 (Right)

100 Gallon Aluminum Rear Fill Fuel Tank, 26" x 48", Fits 2006 & Older, Verify Which Style Manifold Tank Has

P/N 01-060010005 (Left)

P/N 01-060010006 (Right)

100 Gallon Aluminum Rear Fill Fuel Tank, 26" x 48", Fits 2008 & Newer, Verify Which Style Manifold, Pictured Below



P/N 01-060011001 (Left)

P/N 01-060011002 (Right)

110 Gallon Aluminum Rear Fill Fuel Tank, 23" x 57", Fits 2006 & Older, Verify Which Style Manifold

P/N 01-060012501 (Left)

P/N 01-060012502 (Right)

125 Gallon Aluminum Rear Fill Fuel Tank, 26" x 57", Fits 2006, Verify Which Style Manifold, Pictured Below



P/N 01-060012503 (Left)

P/N 01-060012504 (Right)

125 Gallon Aluminum Rear Fill Fuel Tank, 26" x 57", Fits 2008 & Newer, Verify Which Style Manifold

P/N 01-060013501 (Left)

P/N 01-060013502 (Right)

135 Gallon Aluminum Rear Fill Fuel Tank, 26" x 66", Fits 2006 & Older, Verify Which Style Manifold, Pictured Below



P/N 01-060013508 (Left)

P/N 01-060013509 (Right)

135 Gallon Aluminum Rear Fill Fuel Tank, 26" x 66", Fits 2006 & Newer, Verify Which Style Manifold, Pictured Below



P/N 01-060013510 (Left)

P/N 01-060013511 (Right)

135 Gallon Aluminum Rear Fill Fuel Tank, 23" x 72", Fits 2006 & Older, Verify Which Style Manifold

P/N 01-060015001 (Left)

P/N 01-060015002 (Right)

150 Gallon Aluminum Rear Fill Fuel Tank, 26" x 72", Fits 2006 & Older, Verify Which Style Manifold, Pictured Below



P/N 01-060015007 (Left)

P/N 01-060015008 (Right)

150 Gallon Aluminum Rear Fill Fuel Tank, 26" x 72", Fits 2006 & Newer, Verify Which Style Manifold, Pictured Below



P/N 01-060015009 (Left)

P/N 01-060015010 (Right)

150 Gallon Aluminum Rear Fill Fuel Tank, 23" x 82", Fits 2006 & Older, Verify Which Style Manifold

H WHEELS & ACCESSORIES

P/N 09-20132231 (22.5")

P/N 09-20132431 (24.5")

Accuride Aluminum Wheel, Steer/Drive, Pictured Below



P/N 09-2015221 (22.5", 2 Hand Holes)

P/N 09-2015242 (24.5", 5 Hand Holes)

Hub Pilot White Powder-Coated Steel Wheel w/Hand Holes, 10 Hole Wheel, Can Be Used As Steer Or Drive Axle Wheel, 70 lbs, Fits 2008-2018

**SAVE TIME
& SHIPPING
COSTS.**

Get many quality products
conveniently from one provider.



855-220-8608

*** High Quality Aftermarket Replacement Part (Not OEM Parts).

All items represented are aftermarket replacement parts. If you require OEM parts, please contact your nearest authorized Peterbilt dealer. Four State Trucks is not affiliated with Paccar or Peterbilt.

Fit **PETERBILT 386**

www.BestFitTruckParts.com
855-220-8608

AFTERMARKET COLLISION PARTS

EXHAUST PARTS FOR PETERBILT 386

- 1 P/N 09-08506007
5" O.D. x 60" Turnout Chrome
Top Stack, *Other Styles Available*
- 2 P/N 01-08446620
5" Upper Exhaust Mount Clamp,
Replaces OE 14-14622
- 3 P/N 09-0800009
5" Stainless Steel Flat Band Clamp
P/N 09-0800010
5" Stainless Steel Preformed Band Clamp
- 4 P/N 01-0808015 (Left)
P/N 01-0808016 (Right)
Exhaust Shield Lower Mount Clamp,
Replaces OE 14-14696L, 14-14696R
- N/A ELBOW PLAIN BOM,
Replaces OE 14-14425L, 14-14425R
- 5 P/N 09-0804524
5" x 24" Stainless Steel Flex Pipe
- 6 P/N 01-0806001
5" O.D. Y-Pipe, *Replaces OE 14-15353-0150*
- N/A STAINLESS STEEL EXHAUST SHIELD,
Replaces OE 14-14785R
- 7 P/N 01-08446910
Exhaust Shield Grab Handle, *Replaces OE 14-14691*
- 8 P/N 01-0808014K24
Exhaust Shield Mount Clamp, *Replaces OE 14-14695*
- 9 P/N 09-0805001
5" Guillotine U Bolt Plain Exhaust Clamp
- 10 P/N 09-080100004
5" O.D. Steel Extension Pipe, *Need 5 Ft For Install*
- N/A 5" O.D. x 4" O.D. EXHAUST DOWN PIPE,
90 Degree, *Replaces OE M0-6149-0470-0220*
- 11 P/N 09-0800050
4" Stainless Steel Band Clamp
- 12 P/N 09-080441
4" Stainless Steel Flex Pipe, *Sold By The Foot*
- N/A 4" EXHAUST HEAT SHIELD,
Replaces OE 14-01308
- N/A EXHAUST HEAT SHIELD CLAMP,
Replaces OE 05-19066-450

*DPF Exhaust Connectors Available, Please
Call For More Info*

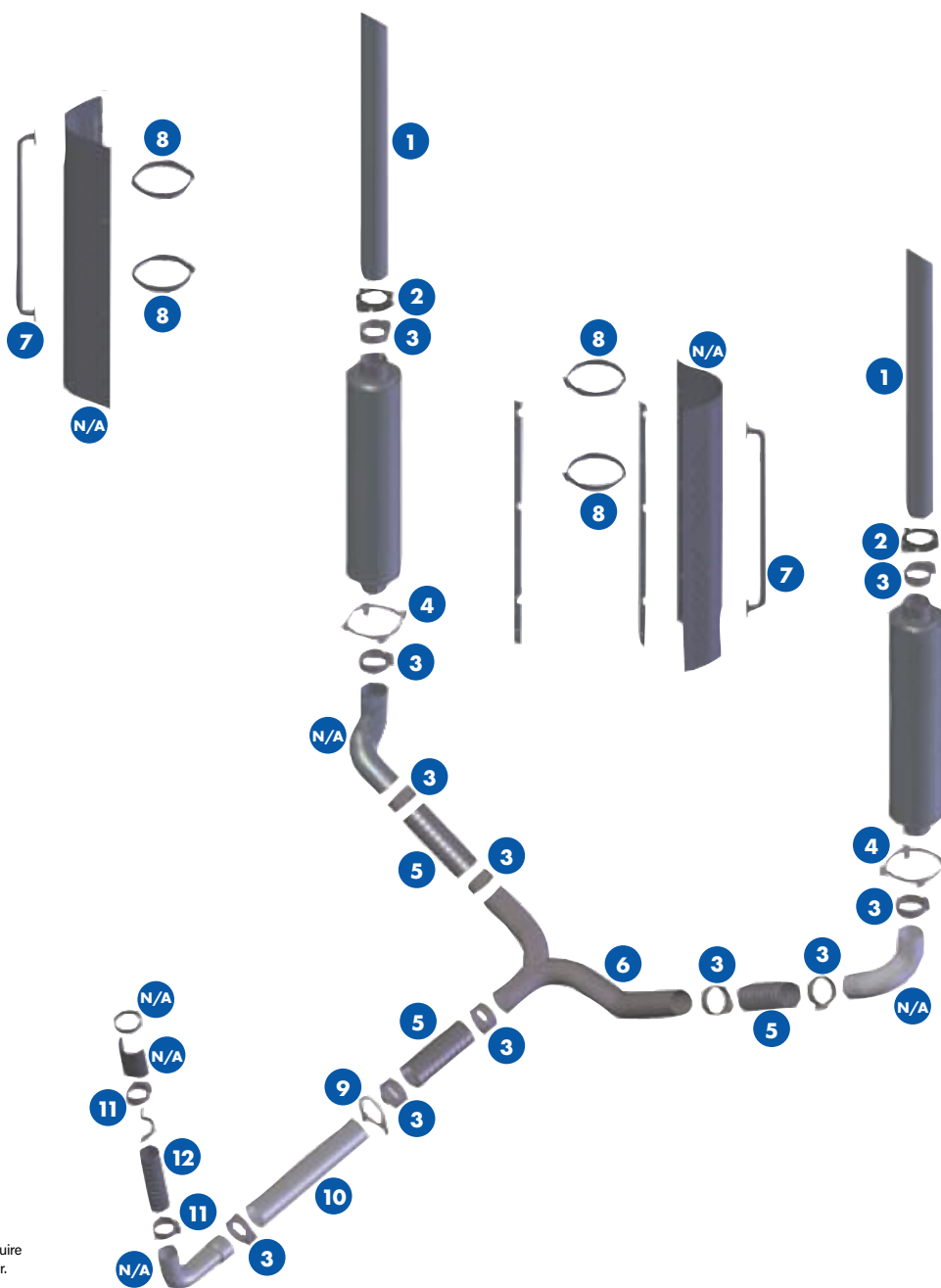

*** High Quality Aftermarket Replacement Part (Not OEM Parts).

All items represented are aftermarket replacement parts. If you require OEM parts, please contact your nearest authorized Peterbilt dealer. Four State Trucks is not affiliated with Paccar or Peterbilt.