

AFTERMARKET COLLISION PARTS



A BUMPERS

P/N HH001015

12" Chrome Set Back Axle Wrap Around Bumper w/Tow Holes, Fits 1987-1996, Pictured Below



P/N HH201015

12" Chrome Set Back Axle Wrap Around Bumper w/Tow & Fog Light Holes, Fits 1987-1996

P/N HN001015

12" Chrome Set Back Axle Bumper w/Tow Holes, Fits 1997-2000

P/N HN201015

12" Chrome Set Back Axle Bumper w/Tow & Fog Light Holes, Fits 1997-2000

P/N HI201018

13" Chrome Set Forward Axle Bumper w/Tow & Fog Light Holes, Fits 1987-1991

P/N HJ001018

13" Chrome Set Forward Axle Bumper w/Tow Holes, Fits 1991 & Newer

P/N HJ201018

13" Chrome Set Forward Axle Bumper w/Tow & Fog Light Holes, Fits 1991 & Newer, Pictured Below



P/N HH001016

16" Chrome Set Back Axle Bumper w/Tow Holes, Fits 1987-1996

B ENGINE COOLING PARTS AC CONDENSERS

P/N 01-070000

AC Condenser, 28.25" Width, 27.25" Height, 1.25" Thick, Replaces OE 18-03809, 18-04015, Fits 1993-2000



P/N 01-070003

AC Condenser, 8" Width, 31" Height, 1" Thick, Replaces OE 18-03554, Fits 1987-1993, Pictured Below



CHARGE AIR COOLER

P/N 01-070103

Charge Air Cooler, Replaces OE 05-18730L 05-18731, Fits 1995-2001, Pictured Below



P/N 01-070109

Charge Air Cooler, Replaces OE 05-16673, 05-16674, Fits 1989-1994, Pictured Below



P/N 29-070100

Charge Air Cooler Hose & Clamp, Includes (2) 4" Hoses & (4) Stainless Clamps, Fits 2008-2011

METAL RADIATOR

P/N 01-070205

4 Row Brass/Copper Radiator, 36.25" Width, 34.62" Height, 2.81" Thick, 2.5" I.D., 3" O.D., Replaces OE 07-06657-A011, Fits 1995-2000



RADIATOR ACCESSORIES

P/N 29-070207

Support Bushings, For Radiators w/Bottom Mounts, Contains 2 Bushing Halves & 1 Sleeve, Need 2 Per Truck, Fits 1987-2000

P/N 01-070240

Stainless Lower Coolant Tube, 90 Degree w/Tab, For CAT 3406E or C15, Fits 1995-2000

P/N 01-070241

Stainless Upper Coolant Tube, Double Bend, For CAT 3406E or C15, Fits 1995-2000

FAN SHROUDS

P/N 01-070600 (1995-2000)

P/N 01-070601 (1995 & Older)

Fiberglass Fan Shroud, For CAT Motor, Replaces OE 07-06688M002, 07-06688M001, Fits 1995-2000, Pictured Below



ENGINE PARTS

P/N 01-070701

Washer Reservoir, Replaces OE R86-6001, Fits 1995-2005, Pictured Below



P/N 29-070701

Washer Reservoir Cap, Replaces OE 63361, Fits 1990-2005

P/N 29-073680063

Flywheel Housing, Fits Cummins ISX Replaces OE 3412303, 4026795

P/N 29-074952540

Oil Pan, Fits Cummins ISX, Replaces OE 3680530, 3680531

C GRILLES

P/N 01-1210304

Aftermarket Stainless Steel Grille Insert, Standard Style, Replaces OE 13-03507, Fits 1987-2007, Pictured Below



P/N 01-1210511

Stainless Steel 4 Piece Grille Surround, For Set Back Axle, Includes Top Crown, Sides & Bottom, Replaces OE 13-04537P, 13-04538L-P, 13-04538R-P, 13-04539P, Fits 1987-2007

P/N 01-1210520

Polished Aluminum 2 Piece Grille Upper & Lower Trim Ring Set, Replaces OE 13-03529P, 13-03530P, RPPG011, RPPG013

P/N 01-1210513

Stainless Steel Grille Surround Bolt Kit, Replaces OE 13-03507, Fits 1987-2007

P/N 01-120702

Bug Screen/Inner Rock Guard Behind Grille, Replaces OE 13-04345, RG-1972, Fits 1988-2004

*** High Quality Aftermarket Replacement Part (Not OEM Parts).

All items represented are aftermarket replacement parts. If you require OEM parts, please contact your nearest authorized Peterbilt dealer. Four State Trucks is not affiliated with Paccar or Peterbilt.

PETERBILT 377

www.BestFitTruckParts.com
855-220-8608

AFTERMARKET COLLISION PARTS



D HOODS & RELATED

P/N 01-12400

Hood Cone Support Kit, Includes Hood Rest, Mount Bushings Sleeve & Washer Nuts, Replaces OE 13-01840, Pictured Below



P/N 29-124000

Hood Latch Kit, Need 2 Per Truck, Replaces OE L56-0001, 13-04339, 23-13857, Pictured Below



P/N 01-124003

Hood Spring, For Short Hood, Replaces OE 13-03879, Pictured Below



P/N 01-124004

Hood Cable, Heavier Cable Gauge & Upgraded Materials, Replaces OE 13-03512, L92-6000-0718, Pictured Below



P/N 01-12402

Black Poly Hood Rest, Replaces OE 13-03510, Pictured Below



P/N 01-12403

Red Poly Hood Roller, 1.5" O.D. x 1.75" Width, Replaces OE 13-03593, Fits 1987-2000

P/N 01-12406

Black Poly Hood Roller, 1.125" O.D. x 1.5" Width, Replaces OE 13-04391, Fits 1987-2000

P/N 01-12410

Hood Hinge Bushing Kit, For 1 Hinge, Need 2 Per Truck, Includes 1 Square & 3 Round w/Sleeves, Replaces OE 13-04164, 13-04154, Fits 1987-2000, Pictured Below



P/N 01-12440 (Left)

P/N 01-12441 (Right)

Hood Pivot Assembly, Replaces OE 13-04730L, 13-04730R, Fits 1987-2000, Pictured Below



P/N 01-12434 (Left)

P/N 01-12435 (Right)

Lower Hood Pivot, Replaces OE 13-04708L, 13-04708R, Fits 1987-2000, Pictured Below



P/N 01-12432 (Left)

P/N 01-12433 (Right)

Dogbone Hood Pivot, Replaces OE 13-04626L, L486026L, 13-04626R, L486026R, Fits 1987-2000, Pictured Below



P/N 01-12431

Hood Pivot Bolt Kit, Replaces OE 23-15273, Fits 1987-2000

P/N 01-12436

Hood Pivot/Hinge Bushing, Replaces OE 13-04726, Fits 1987-2000

E CAB & RELATED CAB LIGHTS

P/N 09-1608078

Square Cab Light, Grakon Style, Pictured Below



P/N 09-1608079

Square LED Cab Light, Grakon Style, Pictured Below



AIR HORNS & RELATED

P/N 09-051327

25" Chrome Air Horn, Square, Hadley Style

P/N 09-051333

29" Chrome Air Horn, Square, Hadley Style, Pictured Below



MIRRORS & RELATED

P/N 09-0915011

Stainless Steel Mirror Head, Pictured Below



P/N 09-0915007

Heated Mirror Head, Pictured Below



P/N 09-0915006

Heated/Motorized Mirror Head, Pictured Below



P/N 09-0915003

8.5" Spot Mirror, Center Stud, Pictured Below



P/N 09-0915004

8.5" Spot Mirror, Offset Stud, Pictured Below



P/N 01-091501

Stainless Steel Outer Mirror Bracket, For Door Mounted Mirrors, Fits 2004 & Older, Pictured Below



DOOR ACCESSORIES

P/N 01-0914078 (Left)

P/N 01-0914079 (Right)

Stainless Steel Exterior Door Handle, Replaces OE 20-08179L, 20-08179R, Pictured Below



P/N 01-0914087

Door Latch Striker Pin, Replaces OE 20-12972, Fits 1987-2000

P/N 01-0914050 (Left)

P/N 01-0914051 (Left)

Stainless Steel Door Hinge, Does Not Have Notch At Top For Wire Boot, Taper On The Holes For The Door Side Of Hinge Are Smaller, Have To Use 359 Door Screws Or Cut Taper Larger, Pictured Below



P/N 01-1530042

Door Stop Kit, Fits 1987-2005

*** High Quality Aftermarket Replacement Part (Not OEM Parts).

All items represented are aftermarket replacement parts. If you require OEM parts, please contact your nearest authorized Peterbilt dealer. Four State Trucks is not affiliated with Paccar or Peterbilt.

AFTERMARKET COLLISION PARTS



F FUEL TANKS & RELATED FUEL TANK ACCESSORIES

P/N 29-0601008 (w/Lip)
P/N 29-0601009 (w/o Lip)
4" Fuel Tank Strap Rubber Liner w/Outside Lip, Sold By The Foot, Pictured Below



P/N 09-060302
Safety Vent .5" Thread, Fits 1987-2000, Pictured Below



P/N 01-060302
Safety Vent 1.25" Thread, Fits 1987-2000, Pictured Below



P/N 29-060313
Adjustable Fuel Sender Fits 6" to 27" DIA. Tanks, 240 to 33 OHM, Pictured Below



P/N 01-060304
Fuel Sender For 26" Dia. Fuel Tanks, Includes OE Style Plug, Replaces OE K21-6001-661, Fits 1987-2011, Pictured Below



P/N 29-060304
Return High Flow Fuel Splitter, Pictured Below



FUEL TANK CAPS

P/N 01-060301 (Non-Locking)
P/N 01-060312 (Locking)
Non-Locking Non-Vented Fuel Tank Cap w/Pressure Relief, Fits 1985-1987, Pictured Below



FUEL TANK STRAPS

P/N 01-0601010
P/N 01-0601011 (Bracket Only)
4" Aftermarket Non-Polished Aluminum Fuel Tank Strap For 26" Dia. Tanks, Will Fit Stock Tank Brackets, Strap Liner, Sold Separately, Replaces OE 11-03596, Fits 1988-2004, Pictured Below



P/N 01-0601012
4" Aftermarket Polished Aluminum Fuel Tank Strap For 26" Dia. Fuel Tanks, Will Fit Stock Tank Brackets, Strap Liner, Sold Separately, Fits 1988-2000, Pictured Below



FUEL TANKS

P/N 01-060010003 (Left)
P/N 01-060010004 (Right)
100 Gallon Aluminum Rear Fill Fuel Tank, 26" x 38", Fits 2006 & Older, Verify Which Style Manifold Tank Has, Pictured Below



P/N 01-060012501 (Left)
P/N 01-060012502 (Right)
125 Gallon Aluminum Rear Fill Fuel Tank, 26" x 57", Verify Which Style Manifold, Pictured Below



P/N 01-060013501 (Left)
P/N 01-060013502 (Right)
135 Gallon Aluminum Rear Fill Fuel Tank, 26" x 66", Fits 2006 & Older, Verify Which Style Manifold, Pictured Below



P/N 01-060015001 (Left)
P/N 01-060015002 (Right)
150 Gallon Aluminum Rear Fill Fuel Tank, 26" x 72", Replaces OE 11-03662P, 11-02858, 11-03664P, 11-02939, Pictured Below



G FENDERS & RELATED

P/N 09-11050602
Black Poly Quarter Fenders, Sold As A Pair, Pictured Below



P/N 09-110306041
24" Stainless Steel Quarter Fender w/Tube, Mounts To Standard Post, Post Not Included, Sold As A Pair, Pictured Below



P/N 09-110306000
Stainless Steel Quarter Fenders w/Full Braces, 22" Height x 25" Wide, 13.5" From Bottom To Center Of Mount, Sold As A Pair, Pictured Below



H MUD FLAPS

P/N 01-05070050E
Top Quarter Fender Mud Flap, Replaces OE 1025R, MF0005, Fits 1988-2004, OEM Part Not An Aftermarket Part, Pictured Below



P/N 01-05070120E
24" x 30" Rear Logo Mud Flap, Replaces OE 3050MF, Fits 1988-2004, OEM Part Not An Aftermarket Part, Pictured Below



I WHEELS & ACCESSORIES

P/N 09-20132231 (22.5")
P/N 09-20132431 (24.5")
Accuride Aluminum Wheel, Steer/Drive



*** High Quality Aftermarket Replacement Part (Not OEM Parts).

All items represented are aftermarket replacement parts. If you require OEM parts, please contact your nearest authorized Peterbilt dealer. Four State Trucks is not affiliated with Paccar or Peterbilt.

Fit PETERBILT 377

www.BestFitTruckParts.com
855-220-8608

AFTERMARKET COLLISION PARTS

EXHAUST PARTS FOR PETERBILT 377 & PETERBILT 378

- 1 P/N 29-080001
5" Turbo V-Band Clamp, *Replaces OE 05-15878*
- 2 P/N 01-0801006
5" Turbo Pipe, *Replaces OE 14-15329, Fits 1987-2000*
- 3 P/N 09-0800010
5" Stainless Steel Preformed Band Clamp
- 4 P/N 09-0804524
5" x 24" Stainless Steel Flex Pipe
- N/A 5" EXHAUST SHIELD PIPE
Replaces OE 14-01661
- N/A 5" EXHAUST SHIELD PIPE CLAMP,
Replaces OE 05-11002
- 5 P/N 01-0801003
Multi Bend Exhaust Down Pipe,
Replaces OE 14-14194
- 6 P/N 01-08409240
Exhaust Pipe Mount Clamp,
Replaces OE 14-00924
- 7 P/N 09-0800009
5" Stainless Steel Flat Band Clamp
- N/A 5" STEEL EXTENSION PIPE,
Sold By The Foot
- 8 P/N 01-0806001
5" O.D. Y-Pipe, *Replaces OE 14-15353-0150*
- 9 P/N 01-0801005 (Left)
5" O.D. x 5" O.D. Chrome Exhaust Elbow
BOM, *Replaces OE 14-13906L-C*

P/N 01-08113800 (Left)
Multi Bend Chrome Exhaust Elbow
BOM, *Replaces OE 14-11380-C*
- 10 P/N 01-0801004 (Right)
5" O.D. x 5" O.D. Chrome Exhaust Elbow
BOM, *Replaces OE 14-13906R-C*

P/N 01-08113801 (Right)
Multi Bend Chrome Exhaust Elbow BOM,
Replaces OE 14-11380R-C
- 11 P/N 29-080200
5" I.D. x 10" Dia. Muffler, *Replaces OE M101281*
- 12 P/N 01-08446620
5" Upper Exhaust Mount Clamp,
Replaces OE 14-14622
- 13 P/N 09-08504807
5" O.D. x 48" Turnout Chrome Top Stack,
Other Sizes Available

P/N 09-08506001
5" O.D. x 60" Turnout Chrome Top Stack,
Other Sizes Available

P/N 09-08506007
5" O.D. x 60" Turnout Chrome
Top Stack, *Other Styles Available*
- 14 P/N 01-0808015 (Left)
Exhaust Shield Lower Mount Clamp,
Replaces OE 14-14696L
- 15 P/N 01-0808016 (Right)
Exhaust Shield Lower Mount Clamp,
Replaces OE 14-14696R
- 16 P/N 01-0808014
Exhaust Shield Mount Clamp, *Replaces OE 14-14695*
- N/A EXHAUST SHIELD,
Replaces OE 14-14689
- 17 P/N 01-08446910
Exhaust Shield Grab Handle, *Replaces OE 14-14691*

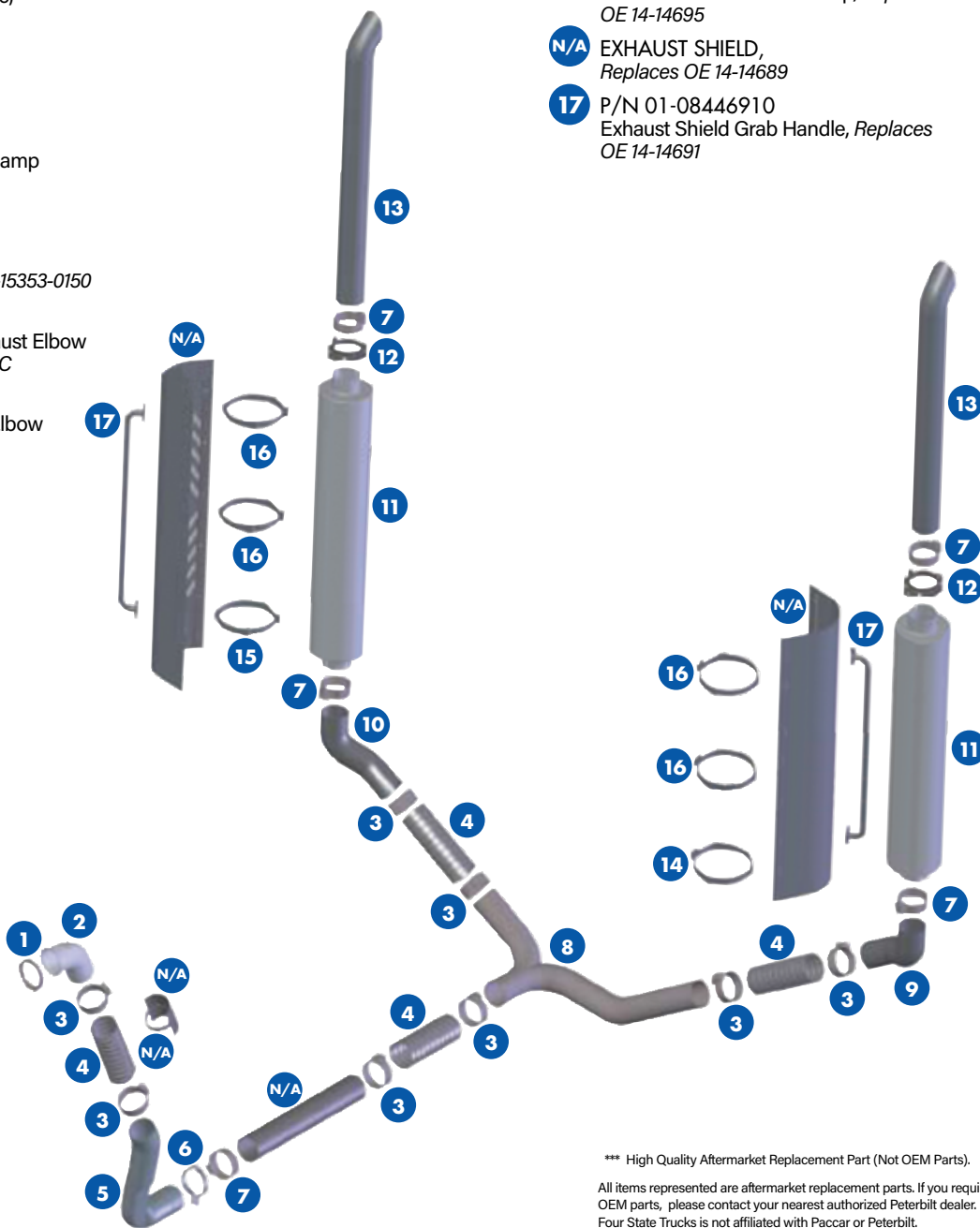

*** High Quality Aftermarket Replacement Part (Not OEM Parts).

All items represented are aftermarket replacement parts. If you require OEM parts, please contact your nearest authorized Peterbilt dealer. Four State Trucks is not affiliated with Paccar or Peterbilt.