

AFTERMARKET COLLISION PARTS



A BUMPERS

P/N 03-010406

Aftermarket Fiberglass Black Bumper, Replaces OE 21-20113-003, Fits 1989-2009, Pictured Below



P/N CI000115

13" Set Back Axle Chrome Bumper w/Center Tow Hole, Brackets Included, Replaces OE HDR 0279B, HDR 0279BX, HDR 0279SSC, ABP N31, OCI000115, ABP N31, PCI000115, TU221021028, HDR0279B, HDR0279BX, HDR0279SSC, ABPN31OCI000115, ABPN31PCI000115, Fits 1989-2009

P/N CI001115

13" Set Back Axle Chrome Bumper w/2 Pin Holes & Center Tow Hole, Brackets Included, Replaces OE HDR 0277B, HDR 0277BX, HDR 0277SSC, ABP N31, PCI001115, ABP N31, OCI001115, HDR0277B, HDR0277BX, HDR0277SSC, ABPN31PCI001115, ABPN31OCI001115, Fits 1989-2009

P/N CI200115

13" Set Back Axle Chrome Bumper w/Center Tow Hole & Square Fog Light Cut Outs, Brackets Included, Fits 1989-2009

P/N CI201115

13" Set Back Axle Chrome Bumper w/2 Pin Holes, Center Tow Hole & Square Fog Light Cut Outs, Brackets Included, Replaces OE A21-26063-001, HDR 0278B, HDR 0278SSC, ABP N31, OCI201115, PCI201115, A2126063001, ABPN31OCI201115, ABPN31PCI201115, Fits 1989-2009

P/N CI000116

16" Set Back Axle Chrome Bumper w/Center Tow Hole, Brackets Included, Fits 1989-2009

P/N CI201116

16" Set Back Axle Chrome Bumper w/2 Pin Holes, Center Tow Hole & Square Fog Light Cut Outs, Brackets Included, Fits 1989-2009

P/N CI200116

16" Set Back Axle Chrome Bumper w/Center Tow Hole & Square Fog Light Cut Outs, Brackets Included, Fits 1989-2009, Pictured Below



P/N CJ001004

16" Set Back Axle Chrome Bumper w/6" Break Back, Center Tow Holes, Replaces OE A21-25210-100, ABP N31, 7CJ001004, A2125210100, ABPN317CJ001004, Fits 1989-2009, Pictured Below



P/N 03-010123

18" Aero Style Chrome Steel Bumper w/Tow Holes & Square Fog Light Holes, Fits 1989-2009, Pictured Below



P/N CI000117S

18" Set Back Axle Chrome Bumper w/Center Tow Holes, Fits 1989-2009

B HEADLIGHTS & TURN SIGNALS

P/N 03-1606002 (Left)

P/N 03-1606003 (Right)

Headlight Assembly w/o Bezel & Turn Signal, Replaces OE A06-15605-002, A06-15605-003, Fits 1989-2009, Pictured Below



P/N 03-1606000 (Left)

P/N 03-1606001 (Right)

Headlight Bezel, Replaces OE 06-15233-000, 06-15233-001, Fits 1989-1996, Pictured Below



P/N 03-160702 (Left)

P/N 03-160703 (Right)

Turn Signal w/Bezel, Replaces OE A06-20738-000, A06-20738-001, Fits 1997-2009, Pictured Below



P/N 03-160701 (Left)

P/N 03-160700 (Right)

Turn Signal, Replaces OE A06-17139-000, A06-17139-001, Fits 1989-1996, Pictured Below



C ENGINE COOLING PARTS AC CONDENSERS

P/N 03-070001

AC Condenser, 10"H x 27.5"W x .625" Core Thickness, Replaces OE 22-32466-001, BOA19757S, N8330619, Fits 1991-2002

P/N 03-070003

AC Condenser, 19"H x 29"W x .75" Core Thickness, Replaces OE 22-39302-000, 22-39302-001, A22-32302-001, N83306170, Fits 1992-1999, Pictured Below

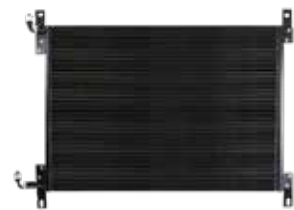

P/N 03-070002

AC Condenser, 20"H x 31.5"W x .75" Core Thickness, Replaces OE 22-42084-002, BOA19893S, N83306275, Fits 2001-2003, Pictured Below



CHARGE AIR COOLERS

P/N 03-070101

Charge Air Cooler, 30.5"H x 21.25"W x 2.75" Core Thickness, 4" Inlet, 4" Outlet, Fits 1989-1994, Pictured Below



P/N 03-070105

Charge Air Cooler, 30.5"H x 21.25"W x 2.75" Core Thickness, 4" Inlet, 4" Outlet, Fits 1994-2005

P/N 03-070125

Super Duty Charge Air Cooler, 36.875"H x 26.25"W x 2.25" Core Thickness, 4" Inlet, 4" Outlet, Fits 2001-2007, Pictured Below

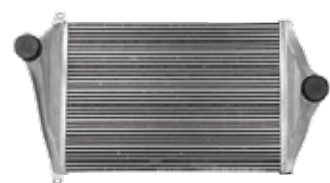

*** High Quality Aftermarket Replacement Part (Not OEM Parts).

All items represented are aftermarket replacement parts. If you require OEM parts, please contact your nearest authorized Freightliner dealer. Four State Trucks is not affiliated with Freightliner.

AFTERMARKET COLLISION PARTS



C ENGINE COOLING PARTS (cont.) CHARGE AIR COOLERS

P/N 03-070110
Charge Air Cooler, 36.875"H x 26.25"W x 2.25" Core Thickness, 4" Inlet, 4" Outlet, Fits 2003-2007

P/N 29-070112
Charge Air Cooler, 34.75"H x 26"W x 2.5" Core Thickness, 4" Inlet, 4" Outlet, Fits 2008-2009, Pictured Below



PTR RADIATORS



Call For More Info On Radiators/Radiator Kits For Your Specific FLD 120 Model

METAL RADIATORS



Call For More Info On Radiators/Radiator Kits For Your Specific FLD 120 Model

RADIATOR ACCESSORIES

P/N 03-070226
Radiator Mount Bushing w/Sleeve, Replaces OE 05-16070-000, A-681-504-00-82, Requires 2 Per Truck, Fits 1992-2003

P/N 03-070215
Coolant Surge Tank, Mounts On Metal Radiator Top Tank, Replaces OE A05-12957-000, Fits 1992-2003, Pictured Below



EGR COOLERS & RELATED

P/N 29-0711001
EGR Cooler Valve, Replaces OE 3104874, 3682805, 3682954, 3682974, 3683305, 3683446, 3684004, 4955422, 4955422NX, 4955422RX, Fits ISX Gen 1 Cummins 2003-2007, Pictured Below



P/N 29-0711002
EGR Cooler Heavy Duty Gasket Kit, Replaces OE 2881747, 2881474NX, 2881784, 2881784NX, 3684448, 4309248, 4309248NX, 4309398, 4955467, 4955926, Fits ISX Gen 2 Cummins 15 Liter 2007-2009, Pictured Below



COOLANT RESERVOIRS

P/N 03-070271
Coolant Reservoir, Replaces OE A05-19234-000, A05-23574-000, Fits 2002-2004, Pictured Below



AC DRIERS & RELATED

P/N 03-070015
3" x 10.25" AC Drier, Replaces OE ABP N83 319744, ABP N83 319745, RF61800504, PH088518-00, PH088539-00, Fits 2002-2009, Pictured Below



P/N 03-070016
3" x 10.25" AC Drier, Replaces OE ABP N83 319614, ABP N83 319615, PH088335-00, Fits 1994-2002

P/N 03-070017
AC Drier Pad Mount Inboard, Replaces OE ABP N83 319015, A22-63633-000, A22-63993-000, A22-65550-000, A22-66700-000, A22-69800-000, A22-72391-000, Fits 2008-2009

P/N 29-070027
4" x 6.25" AC Drier, Replaces OE A22-63633-000, A22-66700-000, A22-63993-000, Fits 2008-2009, Pictured Below



P/N 29-070028
4" x 6.75" AC Drier, Replaces OE A22-63992-000, A22-63992-001, A22-72392-000, Fits 2008-2009

P/N 29-070047
AC Expansion Valve, Replaces OE A2245432000, BOA80332100129, Fits 1991-2000

P/N 03-070024
AC Expansion Valve, Replaces OE ABPN83308107, ABPN83327302, BOAA4965, 7005636, Fits 2001-2007, Pictured Below



ENGINE PARTS

P/N 29-071200
Water Pump, Dome Drive Gear w/Straight Teeth, Press On Gear w/8" Opening, Replaces OE 10R2776, 10R3326, 2243229, Fits C15 Acert Caterpillar 2004-2007, Pictured Below



P/N 29-070701
Windshield Washer Reservoir Cap, Replaces OE FLM-06361, 25133601, 63361, R86-601, 01-070701, Fits 1993-2000

P/N 29-074N754
Exhaust Manifold, Fits CAT 3406B Models 1989-1993, Pictured Below



All items represented are aftermarket replacement parts. If you require OEM parts, please contact your nearest authorized Freightliner dealer. Four State Trucks is not affiliated with Freightliner.

*** High Quality Aftermarket Replacement Part (Not OEM Parts).

AFTERMARKET COLLISION PARTS



C ENGINE PARTS (cont.)

P/N 29-071501914

Exhaust Manifold Kit, Replaces OE 150-1914, 133-3359, C71333359, 1501914, Fits CAT C15 2000-2004

P/N 29-070267

Engine Fan Blade, 32" DIA., 3.5" Projected Width, 2.56" Pilot DIA., 6 Bolt Mounting Clockwise Rotation, Replaces OE 4735-44003-12, Fits 1994-2004, Pictured Below

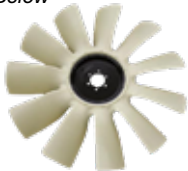

P/N 29-073411458

Front Engine Cover, Accessory Drive Bushing Installed, Replaces OE 3076496, 3078274, 3411458, Fits 1995-2003

P/N 29-077E9520

Replacement Damper, Replaces OE 1678126, 7E9520, Fits CAT C15 1989-2009, Pictured Below

P/N 29-071694153

Flywheel Housing, Replaces OE 2234739, 304156, Fits CAT C15 2000-2009

P/N 29-073680063

Flywheel Housing, Replaces OE 3412303, 4026795, Fits Cummins ISX 2000-2009

P/N 29-0723522643

Flywheel Housing, Replaces OE 23522643, Fits Detroit 60 1994-2009, Pictured Below



P/N 29-0723505073

Flywheel Housing, Replaces OE 23505073, 23505124, Fits Detroit 60 1994-2009



D GRILLES

P/N 03-1210305

Aftermarket Aluminum Grille, Replaces OE A17-12934-009, Fits 1989-2009, Pictured Below



P/N 03-1210402

Aftermarket Stainless Steel Grille, Replaces OE A17-12934-009, Fits 1989-2009, Pictured Below



P/N 03-1210316

Grille Mount Stud Isolator, Replaces OE 17-12127-000, Fits 1989-2009

P/N 03-1204199105

Plain Black Bug Screen, Fits 1989-2008

E HOODS & RELATED

P/N 03-12500

Aftermarket Fiberglass Hood, Includes Front Hinge Bar, 60.5" Length, Replaces OE A17-12443-004, Fits Set Back Axle 1989-2009, Pictured Below



*** High Quality Aftermarket Replacement Part (Not OEM Parts).

All items represented are aftermarket replacement parts. If you require OEM parts, please contact your nearest authorized Freightliner dealer. Four State Trucks is not affiliated with Freightliner.

P/N 03-12552

Aftermarket Fiberglass Hood, 61" Length, Replaces OE A17-10443-000, A17-12443-000, A17-12044-000, A17-12443-002, A17-12442-002, A17-12443-004, A17-12443-003, A17-12442-001, A17-12442-003, Fits 1989-2009, Pictured Below



P/N 03-124002

Hood Springs, Replaces OE 17-12609-000, 17-12609-001, Fits 1989-2009, Pictured Below



P/N 03-124000

Rubber Hood Latch, Fits 1989-2009

P/N 03-124006 (Left)

P/N 03-124007 (Right)

Complete Hood Latch, Replaces OE 17-12435-000, 17-12435-001, Fits 1989-2009, Pictured Below



P/N 03-124003

Hood Latch Kit, 2 Required Per Truck, Replaces OE 17-12438-000, Fits 1997-2007, Pictured Below



P/N 03-124023

Poly Hood Stop, Replaces OE A17-10464-001, Fits 1989-2009

P/N 03-124009

Hood Stop Cable, 11" C To C, Replaces OE A17-12081-000, Fits 1989-2009

P/N 03-124008

Hood Stop Cable, 17.25" C To C, Replaces OE A17-12082-000, Fits 1989-2009, Pictured Below



P/N 03-124024

Hood Stop Cable, 20" C To C, Replaces OE A17-12082-000, Fits 1989-2009, Pictured Below



P/N 03-124012

Hood Hinge Bushing, Replaces OE LOR177005, Fits 1989-2009, Pictured Below



P/N 09-123003

8" Tripod Spot Mirror, Fits 1989-2009, Pictured Below



P/N 09-123004

8" Single Arm Spot Mirror, Fits 1989-2009, Pictured Below



AFTERMARKET COLLISION PARTS



F FENDER EXTENSIONS

P/N 03-051201 (Left)
P/N 03-051211 (Right)
Fender Extensions, *Replaces OE*
23-37670-000, 23-37670-001,
Fits 1989-2009, Pictured Below



G CAB & RELATED CAB LIGHTS

P/N 03-1608003 (Amber Lens)
P/N 03-1608004 (Clear Lens)
LED Cab Lights, *Fits Condo Cab,*
Pictured Below



MIRRORS & RELATED

P/N 09-0915011
7" x 16" Stainless Steel Mirror Head, Non
Heated, *Fits 1989-2009*

P/N 09-0915007
Heated Mirror Head, *Fits 1989-2009*

P/N 09-0915008
Heated/Lighted Mirror Head, *Fits 1989-2009*

P/N 09-0915006
7" x 16" Stainless Steel Heated/Motorized
Mirror Head, *Fits 1989-2009*

P/N 09-0915005
7.5" Spot Mirror, Offset Stud, *Fits 1989-2009*

P/N 09-0915003
8" Spot Mirror, Center Stud, *Fits 1989-2009*

P/N 09-0915004
8" Spot Mirror, Offset Stud, *Fits 1989-2009*

P/N 09-0915010
8.5" Spot Mirror, Offset Stud, *Fits 1989-2009*

DOOR ACCESSORIES

P/N 03-0914046 (Left)
P/N 03-0914047 (Right)
Exterior Door Handles, *Replaces OE*
A18-35381-000, A18-35381-001,
A18-28165-000, A18-28165-001
Pictured Below



P/N 03-0914073 (Left)
P/N 03-0914074 (Right)
Door Latch, *Replaces OE A18-17847-000,*
A17-27783-000, A18-17847-001,
A17-27783-001, *Fits 1989-2009,*
Pictured Below



P/N 03-1530003
Chrome Interior Window Handle



H FUEL TANKS & RELATED FUEL TANK ACCESSORIES

P/N 03-060309
Anti-Siphon Tube Insert, *Fits 1989-2009,*
Pictured Below



P/N 29-060305
Return High Flow Splitter, *Fits 1994-2009*

P/N 29-060313
Adjustable Fuel Gauge Sender, For 5" to
27" DIA. Tanks, 240 to 33 OHM,
Fits 1989-2009, Pictured Below



P/N 03-060316
Fuel Sending Unit, For 25" DIA. Tanks,
Replaces OE A22-43065-003,
Fits 2005-2009, Pictured Below



FUEL TANK CAPS

P/N 03-060306
Non-Locking Push N Twist Fuel Tank Cap,
Replaces OE 03-34466-000, 03-37017-000,
Fits 1994-2009, Pictured Below



P/N 03-060307
Locking Push N Twist Fuel Tank Cap,
Replaces OE 03-34466-002, 03-37017-002,
Fits 1994-2009

P/N 03-060301
Locking Vented Fuel Tank Cap, *Fits 1989-1993*

FUEL TANK STRAPS

P/N 29-0601008 (w/Outside Lip)
P/N 29-0601009 (w/o Outside Lip)
4" Fuel Tank Strap Rubber Liner, *Fits*
1989-2009, *Sold By The Foot, Pictured Below*



P/N 03-060102
3.6" Fuel Tank Strap w/Brackets For Fuel
Tank Step, Includes Rubber Strap Liner,
Replaces OE A03-38910-000, Fits 23" DIA.
Tanks 2001-2009, Pictured Below



FUEL TANKS

P/N 03-060014001 (Left)
P/N 03-060014002 (Right)
140 Gallon, 23" x 84" Fuel Tank, Filler Neck
22" From Front Seam, *Fits 1994-2009,*
Pictured Below



P/N 03-060011001 (Left)
P/N 03-060011002 (Right)
110 Gallon, 23" x 60" Fuel Tank, Filler Neck
22" From Front Seam, *Fits 1994-2009,*
Pictured Below



FUEL TANK STEPS

P/N 03-06044802 (48")
P/N 03-06047102 (71")
5" Wide Replacement Fuel Tank Step
Assembly, *Fits 1989-2004*

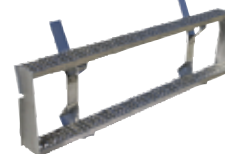

P/N 03-06043601 (36")
P/N 03-06044701 (47")
P/N 03-06045901 (59")
P/N 03-06047101 (71")

5" Wide Replacement Fuel Tank Step,
Fits 1989-2004

I BATTERY BOXES

P/N 03-0501102
25" Smooth Aluminum Battery Box Cover,
Fits 1989-2009

P/N 03-0501103
31" Smooth Aluminum Battery Box Cover,
Fits 1989-2009, Pictured Below



*** High Quality Aftermarket Replacement Part (Not OEM Parts).

All items represented are aftermarket replacement parts. If you require OEM parts, please contact your nearest authorized Freightliner dealer. Four State Trucks is not affiliated with Freightliner.

AFTERMARKET COLLISION PARTS



I BATTERY BOXES (cont.)

P/N 03-0501105
25" Smooth Aluminum Battery Box Cover w/Steps, Fits 1989-2009, Pictured Below



P/N 03-0501106
15.5" Smooth Aluminum Battery Box Cover w/Steps, Fits 1989-2009

P/N 03-051500
Tool Box Lower Step Bracket, Fits 1989-2009 Pictured Below



P/N 03-0501300
31.5" x 5" Aluminum Battery Box Lower Step, Fits 1989-2009, Pictured Below



J FRAME & CHASSIS

P/N 03-051000
Air Bag Airliner II, Replaces OE 16-16730-000, 16-13810-000, 16-13810-002, 16-1413688-002, A16-13688-002, Fits 1989-2009

P/N 03-101404
Air Bag Rear Of Sleeper, 3.15" Diameter Top Plate, 2.87" Diameter Bottom Plate, 2.25" Diameter Plate Center To Center, Parallel Bottom Plate, 5.6" Minimum Height, 12.10" Maximum Height, Replaces OE 18-66715-000, 18-52651-000, 18-40977-000, Fits 1999-2009, Pictured Below



P/N 03-051006
Torque Rod, 23.890"C To C Of Bushings, End Bushing Measurements 4.375" C To C Of Bolt Holes, 0.625" Bolt Holes, 1 End Bushing At 0 Degrees, 1 End Bushing @ 35 Degrees, Rod Diameter 1.660", Replaces OE 16-16749-001, 684-326-67-16, A16-16749-001, 58745615, Fits 1989-2009

P/N 03-051007
Torque Rod, 24.330"C To C Of Bushings, End Bushing Measurements 4.375" C To C Of Bolt Holes, 0.625" Bolt Holes, 1 End Bushing At 0 Degrees, 1 End Bushing @ 35 Degrees, Rod Diameter 1.250", Replaces OE XC454962AA, 16-16749-002, 681-326-72-16, A16-16749-002, 61310445, Fits 1998-2009, Pictured Below



P/N 29-051020
Premium Poly Rotational Bushing And Pin, 2.500" OD Outer Shell, 5.672" C To C Of Bolt Holes, 0.813" ID Bolt Holes, Replaces OE 16005092, 16-16412-001, 3538115C1, Fits 1989-2009

P/N 29-051021
Premium Poly Torque Rod Bushing Taper Stud Mount, 2.500" OD Outer Shell, 3.0" Taper Length, 1.250" x 12" Threads On End, Replaces OE 1693061C1, 35001-5016, 44697-00L, R302228, Fits 1989-2009, Pictured Below



P/N 03-05091000
Cast Iron Spring Hanger Rear of Steer Axle, Replaces OE A16-14019-002, MFL46192, E911-46, 338-2134-03, Fits 1989-2009 w/4" Wide Springs, Pictured Below



P/N 03-05091001
Aluminum Spring Hanger Rear of Steer Axle, Replaces OE A16-14019-002, MFL46192, E911-46, 338-2134-03, Fits 1989-2009 w/4" Wide Springs

P/N 03-050906
2 Leaf Parabolic Spring, 94.2 lbs, Replaces OE A16-13412-001, A16-13739-008, 37968, 53250, Fits 1989-2009, Pictured Below



P/N 03-05091003
1.5 Leaf Parabolic Spring, Replaces OE A16-15316-000, A16790-000, 52057, 52945, Fits 1989-2009

P/N 03-050905
1.25" x 6.906" Pin For Spring Hanger On Steer Axle, Replaces OE 16-12373-00, 03050905, Fits 1989-2009

P/N 03-050903
Cast Aluminum Spring Hanger Rear of Steer Axle, Replaces OE A1612297000, A1612355000, A1612355003, A1612358000, 03050903, A16-12297-000, A16-12355-000, A16-12355-003, A16-12358-000, R308854, Fits 1989-2009 w/4" Wide Springs, Pictured Below



P/N 03-050904
Spring Hanger & Shackle Kit, Includes 4 Washers, 2 Grease Fittings, 4 Lock Nut Set .5" GR 8, 4 Cap Screw .5", 20" x 3" GR 5, 2 Side Bars, 2 Shackle Pins, 1 Spring Hanger w/ Bushing, 4 Shims, 1 Bimetal Bushing 1.5" x 1.25" x 4", 4 U Bolt Washer, Replaces OE 1613798000, A1613798000, 03050904, 16-13798-000, A16-13798-000, Fits 1989-2009 w/4" Wide Springs

P/N 29-050961
U Bolt Kit, .75" x 4" x 8.875", Replaces OE 29050961, 680-322-07-25, K241-309, Fits 1989-2009

OE MUD FLAPS

P/N 03-050703OE
16" x 20" Logo Mud Flap, Replaces PDT1510, OEM Part Not An Aftermarket Part, Fits 1989-2009, Pictured Below



P/N 03-050704OE
24" x 30" Logo Mud Flap, Replaces PDT1513, OEM Part Not An Aftermarket Part, Fits 1989-2009

P/N 03-050701OE
6" x 24" Logo Mud Flap, Replaces PDT1023, OEM Part Not An Aftermarket Part, Fits 1989-2009, Pictured Below



K WHEELS & ACCESSORIES

P/N 09-20132231 (22.5")
P/N 09-20132431 (24.5")
Accuride Aluminum Wheel, Steer/Drive

P/N 09-2015221 (22.5")
P/N 09-2015241 (24.5")
White Steel Wheel, 10 Hole Hub, Steer/Drive

NS FENDERS & RELATED

P/N 09-11050601
Plastic Low Mount Quarter Fenders, Fits 1989-2009, Sold As A Pair

P/N 09-11030601
Stainless Steel Low Mount Quarter Fenders, Fits 1989-2009, Sold As A Pair



All items represented are aftermarket replacement parts. If you require OEM parts, please contact your nearest authorized Freightliner dealer. Four State Trucks is not affiliated with Freightliner.

AFTERMARKET COLLISION PARTS

EXHAUST PARTS FOR FREIGHTLINER FLD 120 SBA, DUAL REAR EXHAUST, 1996-2004

- 1** P/N 09-08506007
5" O.D. x 60" Turnout Chrome
Top Stack, *Other Styles Available,*
Fits 1989-2007
- 2** P/N 09-0800007
5" Chrome Guillotine Clamp,
Fits 1996-2004
- N/A** EXHAUST SHIELD MOUNTING CLAMP,
Replaces OE A04-1211-010,
Fits 1989-2007
- 3** P/N 29-080200
5" I.D. x 10" Dia. Muffler, *Replaces OE*
04-21774-001, Fits 1989-2007
- 4** P/N 09-0800009
5" Stainless Steel Flat Band Clamp,
Fits 1989-2007
P/N 09-0800010
5" Stainless Steel Preformed Band
Clamp, *Fits 1989-2007*
- 5** P/N 03-08130020
Elbow Plain BOM, *Replaces OE*
04-15653-002, Fits 1997-2007
P/N 03-08130030
Elbow Chrome BOM, *Replaces OE*
04-15653-003, Fits 1997-2007
- 6** P/N 03-08130001
Elbow Plain BOM, *Replaces OE*
04-15653-000, Fits 1997-2007
P/N 03-08130010
Elbow Chrome BOM, *Replaces OE*
04-15653-001, Fits 1997-2007
- 7** P/N 09-0804524
5" x 24" Stainless Steel Flex Pipe,
Fits 1996-2004
- N/A** EXHAUST Y PIPE
Replaces OE 04-15679-000,
Fits 1997-2007
- N/A** INTERMEDIATE PIPE
Replaces OE 04-13973-000
- N/A** INTERMEDIATE PIPE
Replaces OE 04-13470-051
- 8** P/N 03-08140130
Turbo Pipe, *Replaces OE*
04-17091-013, Fits 1997-2007
- 9** P/N 29-080001
5" Turbo V-Band Clamp, *Replaces OE*
01-14596-000, Fits 1989-2007
- N/A** EXHAUST SHIELD
Replaces OE 04-16425-000,
Fits 1997-2007

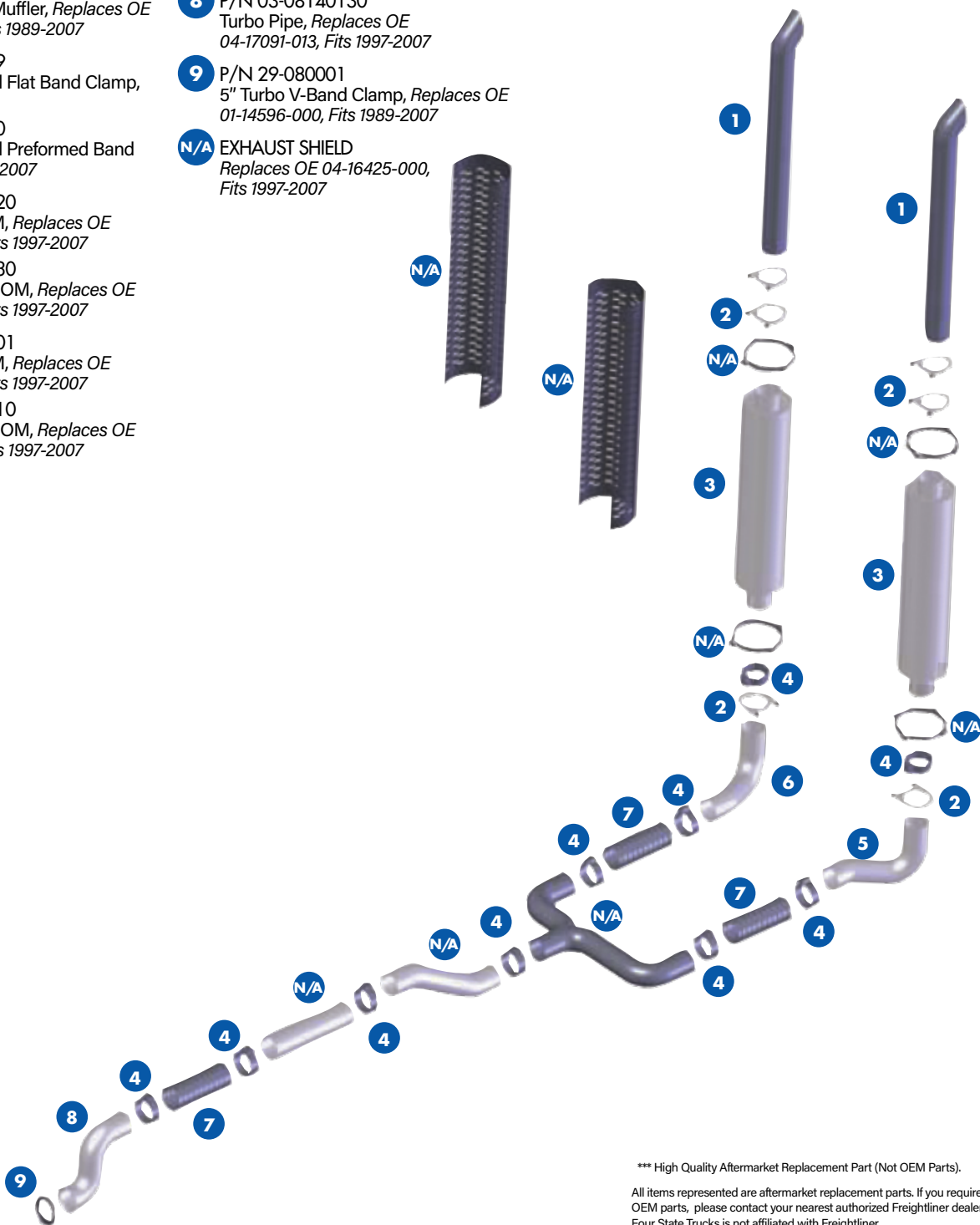

*** High Quality Aftermarket Replacement Part (Not OEM Parts).

All items represented are aftermarket replacement parts. If you require OEM parts, please contact your nearest authorized Freightliner dealer. Four State Trucks is not affiliated with Freightliner.

AFTERMARKET COLLISION PARTS

EXHAUST PARTS FOR FREIGHTLINER FLD 120 SBA, REAR EXHAUST

- | | |
|--|--|
| <p>1 P/N 09-08506007
5" O.D. x 60" Turnout Chrome
Top Stack, Fits 1989-2007,
Other Styles Available</p> <p>2 P/N 09-0800007
5" Chrome Guillotine Clamp,
Fits 1996-2004</p> <p>N/A EXHAUST SHIELD CLAMP
Replaces OE A04-12111-001</p> <p>3 P/N 29-080200
5" I.D. x 10" Dia. Muffler, Replaces OE
04-21774-001, Fits 1989-2007</p> <p>4 P/N 09-0800009
5" Stainless Steel Flat Band Clamp,
Fits 1989-2007</p> <p>P/N 09-0800010
5" Stainless Steel Preformed
Band Clamp, Fits 1989-2007</p> | <p>N/A ELBOW PLAIN BOM
Replaces OE 04-15652-000,
Fits 1989-2007</p> <p>5 P/N 09-0804524
5" x 24" Stainless Steel Flex Pipe,
Fits 1996-2004</p> <p>6 P/N 03-08140010
5" Intermediate Pipe, Replaces OE
04-17131-009, Fits 1989-2007</p> <p>7 P/N 03-08140140
Turbo Pipe, Replaces OE
04-17094-014, Fits 1989-2007</p> <p>8 P/N 29-080001
5" Turbo V-Band Clamp, Replaces OE
01-14596-000, Fits 1989-2007</p> <p>N/A EXHAUST SHIELD
Replaces OE 04-15612-000,
Fits 1989-2007</p> |
|--|--|

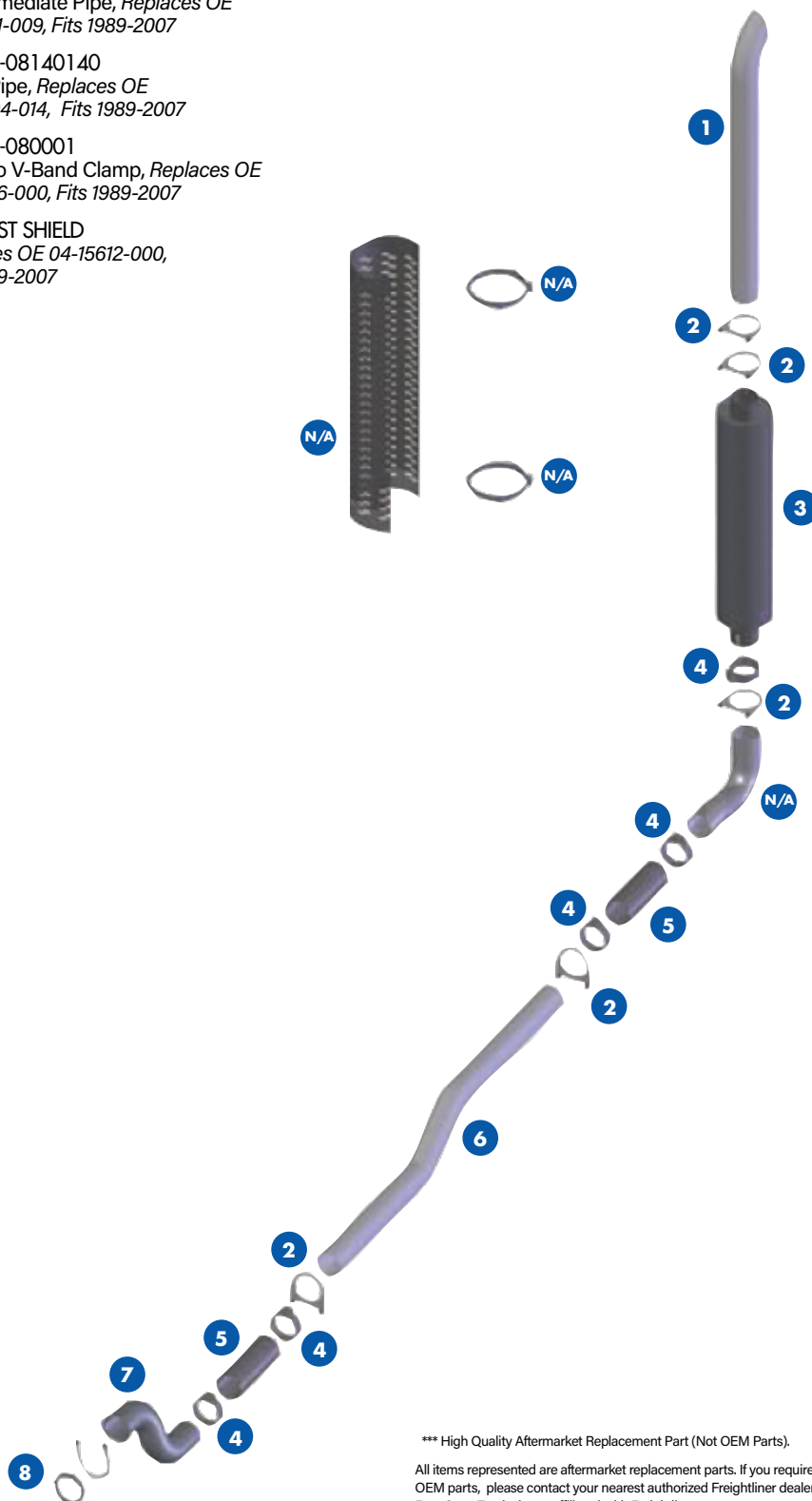

*** High Quality Aftermarket Replacement Part (Not OEM Parts).

All items represented are aftermarket replacement parts. If you require OEM parts, please contact your nearest authorized Freightliner dealer. Four State Trucks is not affiliated with Freightliner.

Fits **FREIGHTLINER FLD120 SBA**
www.BestFitTruckParts.com
855-220-8608

AFTERMARKET COLLISION PARTS

EXHAUST PARTS FOR FREIGHTLINER FLD 120 SBA, SIDE EXHAUST

- 1** P/N 09-08506007
5" O.D. x 60" Turnout Chrome Top Stack, Fits 1989-2007, Other Styles Available
- 2** P/N 09-0800007
5" Chrome Guillotine Clamp, Fits 1989-2009
- N/A** EXHAUST SHIELD MOUNTING CLAMP
Replaces OE A04-1211-010, Fits 1989-2007
- 3** P/N 29-080200
5" I.D. x 10" Dia. Muffler, Replaces OE 04-21774-001, Fits 1989-2007
- 4** P/N 09-0800009
5" Stainless Steel Flat Band Clamp, Fits 1989-2007
P/N 09-0800010
5" Stainless Steel Preformed Band Clamp, Fits 1989-2007
- 5** P/N 03-08170130
Elbow Chrome BOM, Replaces OE 04-09657-013, Fits 1989-2007
- 6** P/N 03-0801001
Extension Pipe, Replaces OE 04-16621-001, Fits 1989-2007
- 7** P/N 03-0806001
Exhaust Y Pipe, Replaces OE A04-16885-024, Fits 1989-2007
- 8** P/N 09-0804524
5" x 24" Stainless Steel Flex Pipe, Fits 1996-2004
- 9** P/N 03-08140150
Turbo Pipe, Replaces OE 04-17094-015, Fits 1989-2007
- 10** P/N 29-080001
5" Turbo V-Band Clamp, Replaces OE 01-14596-000, Fits 1989-2007
- N/A** EXHAUST SHIELD
Replaces OE 04-16424-000, Fits 1989-2007

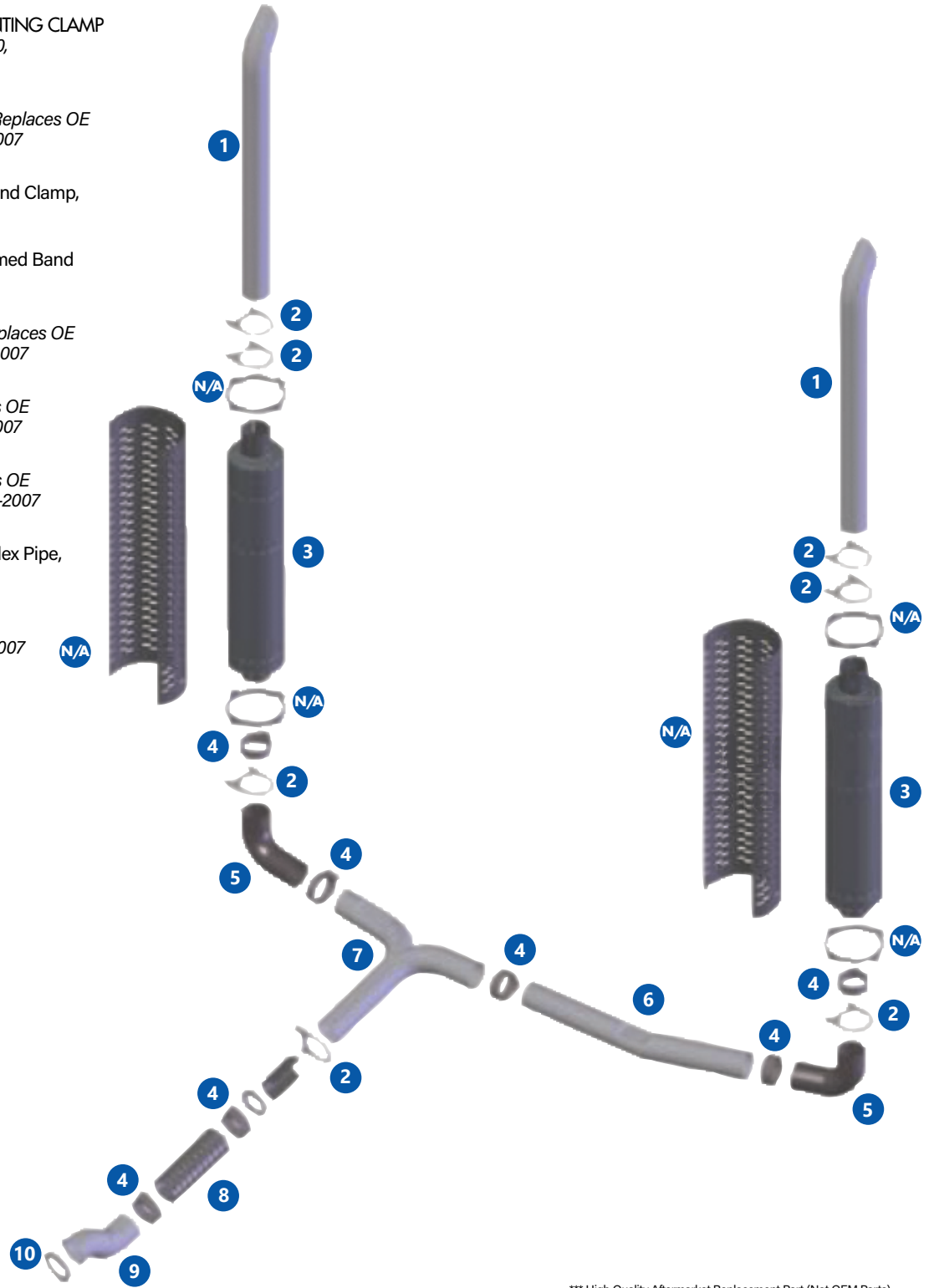

*** High Quality Aftermarket Replacement Part (Not OEM Parts).
All items represented are aftermarket replacement parts. If you require OEM parts, please contact your nearest authorized Freightliner dealer. Four State Trucks is not affiliated with Freightliner.